

AGENDA  
BOARD OF CITY COMMISSIONERS  
January 22, 2013 AT 6:30 P.M.  
COMMISSION CHAMBERS AT CITY HALL  
SHAWNEE, OKLAHOMA

CALL TO ORDER

DECLARATION OF A QUORUM

INVOCATION

REV. BEN WILLIAMS  
WESLEY METHODIST CHURCH

FLAG SALUTE

1. Consider approval of Agenda:
2. Consider approval of Consent Agenda:
  - a. Acknowledge staff will proceed in the instant meeting with the opening and consideration of bids as set forth in Agenda Item No. 6-b and SMA Agenda Item No. 2-a.
  - b. Minutes from the January 7, 2013 meeting.
  - c. Acknowledge the following reports:
    - Project Payment Report for December 2012
    - License Payment Report for December 2012
  - d. Acknowledge Oklahoma Municipal Retirement Fund normal retirement for Dale Wiginton.
  - e. Authorize staff to seek bids/quotes for the replacement of our ProPatch truck.
3. Citizens Participation

(A three minute limit per person)  
(A twelve minute limit per topic)
4. Acknowledge Sales Tax report received January 2013.
5. Discussion, consideration and possible action on acceptance of proposal to replace City Hall Phone System and authorize staff to negotiate contract. *Deferred from October 15, 2012 meeting.*
6. Consider Bids:
  - a. Federal Street Bridge Rehab Project Contract No. COS-PW-12-02 (Award)  
*Deferred from January 7, 2013 meeting*

- b. Bell Street Sidewalk Project Contract No. COS-PW-12-03 (Open)

**RECESS CITY COMMISSION MEETING TO CONVENE SHAWNEE MUNICIPAL  
AUTHORITY AND SHAWNEE AIRPORT AUTHORITY**

**RECONVENE CITY COMMISSION MEETING**

7. New Business  
(Any matter not known about or which could not have been reasonably foreseen prior to the posting of the agenda)
8. Administrative Reports
9. Commissioners Comments
10. Consider an Executive Session to discuss potential claims, litigation or other options regarding encroachment into City's utility service area by other entities as authorized by 25 O.S. §307(B)(4).
11. Consider matters discussed in Executive Session regarding discuss potential claims, litigation or other options regarding encroachment into City's utility service area by other entities as authorized by 25 O.S. §307(B)(4).
12. Adjournment

Respectfully submitted

Donna Mayo, Deputy City Clerk

The City of Shawnee encourages participation from its citizens in public meetings. If participation is not possible due to a disability, notify the City Clerk, in writing, at least forty-eight hours prior to the scheduled meeting and necessary accommodations will be made. (ADA 28 CFR/36)

**Regular Board of Commissioners**

**2. a.**

**Meeting Date:** 01/22/2013

Open Bids

Submitted By: Donna Mayo, Administration

Department: Administration

---

Information

Title of Item for Agenda

Acknowledge staff will proceed in the instant meeting with the opening and consideration of bids as set forth in Agenda Item No. 6-b and SMA Agenda Item No. 2-a.

---

**Regular Board of Commissioners**

**2. b.**

**Meeting Date:** 01/22/2013

Minutes

Submitted By: Donna Mayo, Administration

Department: Administration

---

Information

Title of Item for Agenda

Minutes from the January 7, 2013 meeting.

---

Attachments

Minutes 1-07-13

**BOARD OF CITY COMMISSIONERS PROCEEDINGS**  
**JANUARY 7, 2013 AT 6:30 P.M.**

The Board of City Commissioners of the City of Shawnee, County of Pottawatomie, State of Oklahoma, met in Regular Session in the Commission Chambers at City Hall, 9th and Broadway, Shawnee, Oklahoma, Monday, January 7, 2013 at 6:30 p.m., pursuant to notice duly posted as prescribed by law. Mayor Mainord presided and called the meeting to order. Upon roll call, the following members were in attendance.

Wes Mainord

Mayor

Pam Stephens

Commissioner Ward 1

Linda Agee

Commissioner Ward 2

James Harrod

Commissioner Ward 3-Vice Mayor

Keith Hall

Commissioner Ward 4

John Winterringer

Commissioner Ward 5

Steve Smith

Commissioner Ward 6

ABSENT: None

INVOCATION

Rev. Ray Belford

First Christian Church

FLAG SALUTE

AGENDA ITEM NO. 1:

Consider approval of Agenda.

A motion was made by Vice Mayor Harrod, seconded by Commissioner Hall, to approve the Agenda. Motion carried 7-0.

AYE: Harrod, Hall, Winterringer, Smith, Stephens, Agee, Mainord

NAY: None

AGENDA ITEM NO. 2:

Consider approval of Consent Agenda:

- a. Minutes from the December 17, 2012 regular meeting.
- b. Budget Amendment – PCDA  
*To amend budget for PCDA revenue need to reimburse accounting salaries*
- c. Acknowledge the following minutes:
  - Shawnee Civic and Cultural Development Authority minutes from November 15, 2012
  - Planning Commission minutes from December 5, 2012
- d. Acknowledge Oklahoma Municipal Retirement Fund refund of contributions from the Defined Contribution plan for Jennifer Shafer.
- e. Authorize staff to apply for sub grant of Emergency Management Performance Grant funds from the Oklahoma Department of Emergency Management.
- f. Mayor’s appointments:

Oklahoma Baptist University Authority

Jack Moore          1<sup>st</sup> Partial Term      Expires 08/01/2015  
*Replaces C.L. Craig (resigned effective 10-01-12)*

A motion was made by Mayor Mainord, seconded by Commissioner Winterringer, to approve the Consent Agenda Items a-f. Motion carried 5-0-2.

AYE: Mainord, Winterringer, Smith, Stephens, Agee

NAY: None

ABSTAIN: Harrod, Hall

AGENDA ITEM NO. 3:

Citizens Participation

(A three minute limit per person)

(A twelve minute limit per topic)

There was no Citizens Participation.

AGENDA ITEM NO. 4:

A public hearing to consider an ordinance rezoning property located at 4016 and 4020 North Kickapoo from R-1; Residential (Single Family Dwelling) and C-1; Neighborhood Commercial to C-3; Automotive, Commercial and Recreation Retail. Case No. P21-12 Applicant: Nelmon Brauning. *Deferred from the December 17, 2012 meeting. Continued to the March Planning Commission meeting at the request of the applicant.*

Community Development Director Justin Erickson gave the staff report and requested that this item be deferred to the March 18, 2013 Commission meeting. A motion was made by Vice Mayor Harrod, seconded by Commissioner Winterringer, to defer the item to the March 18, 2013 City Commission meeting. Motion carried 7-0.

AYE: Harrod, Winterringer, Smith, Stephens, Agee, Mainord, Hall  
NAY: None

AGENDA ITEM NO. 5:

A public hearing and consideration of an ordinance rezoning property located at 702 East Main from I-2; Restricted Light Industrial to C-3; Automotive, Commercial and Recreation. Case #P01-13 Applicant: Steve Buoy

Mr. Erickson advised that the Planning Commission recommended denial of this rezoning request. He stated that rezoning the property is warranted, however C-4 (Downtown Business District) is the most appropriate classification. At a future time, the City will initiate a rezoning for that area, however requirements concerning permitted uses will need to be considered.

Mayor Mainord declared a public hearing in session to consider an ordinance rezoning property located at 702 East Main from I-2; Restricted Light

Industrial to C-3; Automotive, Commercial and Recreation. No one appeared in favor/against said rezoning and the public hearing was closed.

A motion was made by Vice Mayor Harrod , seconded by Commissioner Smith, to follow staff's recommendation and deny the ordinance rezoning property located at 702 East Main from I-2; Restricted Light Industrial to C-3; Automotive, Commercial and Recreation. Motion carried 7-0.

AYE: Harrod, Smith, Stephens, Agee, Mainord, Hall, Winterringer

NAY: None

AGENDA ITEM NO. 6:

A public hearing and consideration of an ordinance rezoning property located at the 4200 Block of North Harrison from A-1; Agricultural to C-3; Automotive, Commercial and Recreation. Case #P02-13 Applicant: Landes Engineering

Mayor Mainord declared a public hearing in session to consider an ordinance rezoning property located at the 4200 Block of North Harrison from A-1; Agricultural to C-3; Automotive, Commercial and Recreation. Mr. Carl Packwood appeared in favor of said rezoning and addressed the flood plain issue. No one appeared against said rezoning and the public hearing was closed.

A motion was made by Commissioner Hall, seconded by Commissioner Winterringer, to approve the ordinance rezoning property located at the 4200 Block of North Harrison from A-1; Agricultural to C-3; Automotive, Commercial and Recreation.

Ordinance No. 2495NS was introduced.

AN ORDINANCE CONCERNING THE ZONING CLASSIFICATION OF THE FOLLOWING DESCRIBED PROPERTY: A TRACT OF LAND LOCATED WITHIN GOVERNMENT LOT FOUR (4), SECTION FIVE (5), TOWNSHIP TEN (10) NORTH, RANGE FOUR (4) EAST OF THE INDIAN MERIDIAN, POTTAWATOMIE COUNTY, OKLAHOMA AND BEING FURTHER DESCRIBED AS: BEGINNING AT THE NORTHWEST CORNER OF SAID LOT 4; THENCE N89°13'10"E ALONG THE NORTH LINE OF SAID LOT 4 450.08 FEET TO THE POINT OF BEGINNING; THENCE



N89°13'10"E ALONG THE NORTH LINE OF SAID LOT 4 209.49 FEET; THENCE S01°43'46"E 1328.55 FEET; THENCE S89°05'10"W 527.83 FEET TO A POINT ON THE EAST RIGHT-OF-WAY LINE OF HARRISON AVENUE (SH#18); THENCE N00°56'19"W ALONG SAID RIGHT-OF-WAY LINE 517.59 FEET TO THE SOUTHWEST CORNER OF LOT TWO (2), BLOCK ONE (1), VISION ADDITION, TO THE CITY OF SHAWNEE; THENCE S45°28'09"E 35.64 FEET; THENCE N90°00'00"E 111.17 FEET TO A POINT OF CURVATURE; THENCE SOUTHEASTERLY ALONG A 125.00 FOOT RADIUS CURVE TO THE RIGHT, HAVING A CHORD BEARING OF S78°49'50"E, A CHORD LENGTH OF 48.43 FEET AND AN ARC DISTANCE OF 48.74 FEET TO THE SOUTHEAST CORNER OF SAID LOT 2, BLOCK 2, VISION ADDITION; THENCE N88°53'49"E A DISTANCE OF 116.57 FEET; THENCE N00°56'36"W 848.24 FEET TO THE POINT OF BEGINNING; REZONING SAID PROPERTY FROM A-1; AGRICULTURAL TO C-3; AUTOMOTIVE COMMERCIAL & RECREATION DISTRICT; AND AMENDING THE OFFICIAL ZONING MAP OF THE CITY OF SHAWNEE ACCORDINGLY.

Motion carried 7-0.

AYE: Hall, Winterringer, Smith, Stephens, Agee, Harrod, Mainord

NAY: None

AGENDA ITEM NO. 7:

Receive petition from R Town Real Estate Investments LLC for detachment of the West Half (W/2) of the Northwest Quarter (NW/4) of the Northeast Quarter (NE/4) of Section 17, Township 10 North, Range 2 East of the Indian Meridian, Pottawatomie County, Oklahoma; setting a date for public hearing on the petition; and authorizing staff to issue notice in accordance with law.

A motion was made by Vice Mayor Harrod, seconded by Commissioner Smith, to authorize staff to set a public hearing on the petition received by R Town Real Estate Investments LLC for detachment of the West Half (W/2) of the Northwest Quarter (NW/4) of the Northeast Quarter (NE/4) of Section 17,

Township 10 North, Range 2 East of the Indian Meridian, Pottawatomie County, Oklahoma on February 4, 2013 and to issue notice in accordance with law. Motion carried 7-0.

AYE: Harrod, Smith, Stephens, Agee, Mainord, Hall, Winterringer  
NAY: None

AGENDA ITEM NO. 8: Discussion, consideration and possible action on contract with Shawnee Area Chamber of Commerce to provide services of a Convention and Visitor's Bureau.

City Manager Brian McDougal stated that he believed this to be a good contract. He further stated that the contract will be reviewed by the Contract Review Committee annually beginning this year.

A motion was made by Vice Mayor Harrod, seconded by Commissioner Agee, to approve a contract with Shawnee Area Chamber of Commerce to provide services of a Convention and Visitor's Bureau. Motion carried 6-1.

AYE: Harrod, Agee, Mainord, Hall, Winterringer, Stephens  
NAY: Smith

AGENDA ITEM NO. 9: Consider approval of Retirement for Robert Billins from the Oklahoma Municipal Retirement Fund.

A motion was made by Commissioner Smith, seconded by Commissioner Winterringer, to approve the Retirement for Robert Billins from the Oklahoma Municipal Retirement Fund. Motion carried 7-0.

AYE: Smith, Winterringer, Stephens, Agee, Harrod, Mainord, Hall  
NAY: None

AGENDA ITEM NO.10: Consider Bids:

- a. Federal Street Bridge Rehab Project Contract No. COS-PW-12-02 (Award)

City Engineer John Krywicki requested that the item be deferred to the January 22, 2013 City Commission meeting in order to go over financing and to prepare a budget amendment.

A motion was made by Commissioner Winterringer, seconded by Vice Mayor Harrod, to defer the item until the January 22, 2013 City Commission meeting. Motion carried 7-0.

AYE: Winterringer, Harrod, Mainord, Hall, Smith, Stephens, Agee

NAY: None

AGENDA ITEM NO. 11: New Business (Any matter not known about or which could not have been reasonably foreseen prior to the posting of the agenda)

There was no New Business.

AGENDA ITEM NO. 12: Administrative Reports

City Engineer John Krywicki advised a pre-work meeting was scheduled for January 23, 2013 for the Kickapoo widening project. He stated utilities relocation would begin on February 1, 2013.

AGENDA ITEM NO. 13: Commissioners Comments

Commissioner Smith advised there would be a Martin Luther King Celebration at the Union Baptist Church on January 13, 2013 at 3:00 p.m.

Commissioner Smith suggested that the City pay one-half of Bill Geist's bill for work performed for the Greater Shawnee Area Chamber of Commerce.

Commissioner Smith also asked Fire Chief David Short to speak regarding the dangers of carbon monoxide poisoning. Chief Short spoke briefly regarding this danger and also informed citizens about the smoke detector program sponsored by the Shawnee Fire Department.

Commissioner Smith also asked City Attorney Mary Ann Karns to report on the current status of city warrants. Ms. Karns reported that the marshals are doing a good job in serving and collecting on warrants through warrant sweeps

and are also staying current in processing new warrants.

AGENDA ITEM NO. 14:

Adjournment

There being no further business to be considered, the meeting was adjourned by power of the Chair. (7:08 p.m.)

---

WES MAINORD, MAYOR

ATTEST:

---

PHYLLIS LOFTIS, CMC, CITY CLERK

**Regular Board of Commissioners**

**2. c.**

**Meeting Date:** 01/22/2013

Reports

Submitted By: Donna Mayo, Administration

Department: Administration

---

Information

Title of Item for Agenda

Acknowledge the following reports:

- Project Payment Report for December 2012
  - License Payment Report for December 2012
- 

Attachments

Project Payment

License Payment

\*\* GENERAL LEDGER DISTRIBUTION \*\*

FUND G/L ACCOUNT	ACCOUNT NAME	AMOUNT
001-2133	UBCC FEE PAYABLE	276.00CR
001-4202	BUILDING PERMITS	6,148.85CR
001-4203	PLUMBING PERMITS	2,140.00CR
001-4204	ELECTRICAL PERMITS	60.00CR
001-4205	ZONING PERMITS & APPLICATIONS	560.00CR
001-4206	HEATING & A/C PERMITS	730.00CR
001-4249	OTHER PERMITS	250.00CR
001-4822	OTHER MISC. REVENUE	34.50CR
101-4249	OTHER PERMITS	100.00CR
501-4510	WATER TAPS	2,250.00CR
799-1023	BANCFIRST GENERAL	12,549.35

\*\* SEGMENT CODE TOTALS \*\*

SEGMENT CODE	DESCRIPTION	TOTAL PAID
B1-NEW	BUILDING CONSTRUCTION NEW	9,356.50CR
B3-REMODEL	BUILDING CONSTRUCTION REM	231.65CR
B4-OTHER	BUILDING CAPORT/SHELTER	141.70CR
E3-REMODEL	ELECTRICAL REMODEL/REPAIR	73.50CR
M3-REMODEL	MECHANICAL REMODEL/REPAIR	784.00CR
P2-ADD	PLUMBING ADDITION	179.00CR
P3-REMODEL	PLUMBING REMODEL	833.00CR
P5-SEPTIC	SEPTIC PERMIT	40.00CR
X-BORE/CUT	BORING & PAVING CUT PERMI	100.00CR
X-DEMO	DEMOLITION PERMIT	50.00CR
Z-OCCUP	OCCUPANCY PERMIT	200.00CR
Z-REZONING	REZONING REQUEST	560.00CR
	TOTAL	12,549.35CR

\*\* FEE CODE TOTALS \*\*

FEE CODE	DESCRIPTION	FEE	PAYMENT DISTRIBUTION			TOTAL PAI
			PENALTY	TAX	INTEREST	
ALARM	BURGLAR/FIRE ALARM LICENSE	3	75.00CR			75.00
ALARMRENEW	BURGLAR/FIRE ALARM RENEW	11	165.00CR			165.00
AUC	AUCTIONEER LICENSE FEE ANNUAL	1	100.00CR			100.00
ELEC2	ELECTRICAL CONTRACTOR RENEW	8	625.00CR			625.00
HUNT2	MIGRATORY FOWL	2	16.00CR			16.00
LAKE-IN	LAKE LEASE CITY RESIDENT	4	800.00CR			800.00
LAKEINSP	LAKE LEASE INSPECTION	5	375.00CR			375.00
LAKELEASE	LAKE LEASE	8	5,005.00CR			5,005.00
MECH1	MECHANICAL CONTRACTOR INTIAL	1	100.00CR			100.00
MECH2	MECHANICAL CONTRACTOR RENEW	5	375.00CR			375.00
PLUM1	PLUMBING CONTRACTOR INITIAL	1	100.00CR			100.00
PLUM2	PLUMBING CONTRACTOR RENEW	1	75.00CR			75.00
RESAL	RESIDENTIAL SALE	16	160.00CR			160.00
TREE	TREE TRIMMING LICENSE FEE	1	25.00CR			25.00
TOTAL			7,996.00CR			7,996.00



**Regular Board of Commissioners**

**2. d.**

**Meeting Date:** 01/22/2013

Retirement Wiginton

Submitted By: Donna Mayo, Administration

Department: Administration

---

Information

Title of Item for Agenda

Acknowledge Oklahoma Municipal Retirement Fund normal retirement for Dale Wiginton.

---

**Regular Board of Commissioners**

**2. e.**

**Meeting Date:** 01/22/2013

ProPatch Truck

Submitted By: Donna Mayo, Administration

Department: Administration

---

Information

Title of Item for Agenda

Authorize staff to seek bids/quotes for the replacement of our ProPatch truck.

---

Attachments

Request Propatch truck

**Mayor**

WES MAINORD

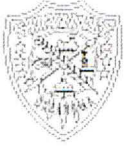

**The City of Shawnee**

PO Box 1448

Shawnee Oklahoma 74802-1448

(405) 273-1250 Fax (405) 878-1581

[www.ShawneeOK.org](http://www.ShawneeOK.org)

**Commissioners**

PAM STEPHENS

LINDA AGEE

JAMES HARROD

KEITH HALL

JOHN WINTERRINGER

STEVE SMITH

**MEMORANDUM**

Date: January 16, 2013

To: Brian McDougal, City Manager

From: John Krywicki, P.E., City Engineer 

**Re: Request Authorization to seek Bids for the replacement of the ProPatch Truck**

We are requesting to seek bids/quotes for the replacement of the ProPatch Truck. Our current equipment has reached the limit of its usefulness (see Attached memo from Frank Loman, Shawnee Construction Manager/Streets Superintendent). We did budget this fiscal year (FY12-13) \$140,000 for the proposed replacement which had been approved during the budget process last year (see Attached Capital Outlay Budget Report).

If you have any questions or need additional information, please advise.

# Memo

---

**To:** John Krywicki  
**From:** Frank Loman  
**Date:** 1/16/2013  
**Re:** Replacement of Patch Truck

---

**John:**

The street department has budgeted for fiscal year 2012-2013 replacement of our existing Pro-Patch asphalt truck. At present the existing truck which is a 2002 GMC vehicle with 83,000 miles on it. Issues with the heating elements on the asphalt bed continue, which we have had the garage, outside sources and an electrician try to resolve with no success. At present we can only purchase what asphalt will be used in a day's time and then only limited quantities if the weather is cooler, because the material will set up in the bed. Other issues with the unit is the tack oil tank and applicator, it continues to clog up with sludge since the heating issue is part of the control environment of the truck. The electrical issues with the asphalt control of temperatures are the main concern.

We have researched replacement of another asphalt body for this truck but the controls and connections for matching up to our unit make it impossible since technology has changed over the last ten years, it can be done but upgrading our ten year old truck which seems like just throwing more money into a aged vehicle.

To replace the truck unit we have found that a new Freightliner is one of only two trucks that are built to adapt to a Pro Patch unit. They are built with the connections and hydraulic controls at the factory for making this connection. The other vehicle that is built for this application is the International truck, but they are having recalls on their 2012 units, which is why we are leaning towards the Freightliner.

Sincerely,

Frank Loman

# CITY OF SHAWNEE

## CAPITAL OUTLAY BUDGET REPORT

FY 12-13

FUND	ACCOUNT	PROJECT	LINE	DESCRIPTION	BUDGET	ACTUAL	ENCUMBRANCES	BALANCE
<b>STREETS</b>								
CAPITAL OUTLAY - BLDGS/IMPRV								
301	5-0920-5420	308	0920-56	FLEX O METER	11,000.00	0.00	10,268.03	731.97
301	5-0920-5420	308	0920-57	GRINDLAZE	18,000.00	0.00	6,880.14	11,119.86
TOTAL CAPITAL OUTLAY - BLDGS/IMPRV					29,000.00	0.00	17,148.17	11,851.83
CAPITAL OUTLAY - EQUIPMENT								
301	5-0920-5450	308	0920-51	BACKHOE	96,000.00	0.00	0.00	96,000.00
301	5-0920-5450	308	0920-52	PATCH TRUCK	140,000.00	0.00	0.00	140,000.00
301	5-0920-5450	308	0920-53	SOFT CUT CONCRETE SAW	9,500.00	0.00	0.00	9,500.00
301	5-0920-5450	308	0920-54	HYDRALIC GRINDER	15,000.00	0.00	0.00	15,000.00
301	5-0920-5450	308	0920-55	BATTERY BACK UP	3,300.00	0.00	3,225.00	75.00
301	5-0920-5450	308	0920-56	FLEX O METER	11,000.00	0.00	0.00	11,000.00
301	5-0920-5450	308	0920-57	GRINDLAZE	18,000.00	0.00	0.00	18,000.00
301	5-0920-5450	308	0920-58	3/4 TON FLAT BED TRUCK	30,510.00	0.00	0.00	30,510.00
301	5-0920-5450	308	0920-59	DUMP TRUCK	90,937.00	0.00	0.00	90,937.00
301	5-0920-5450	308	0920-60	FLAT BEDS FOR TRUCKS	9,400.00	0.00	0.00	9,400.00
301	5-0920-5450	308	0920-61	PAINT STRIPPER	15,000.00	14,885.00	0.00	115.00
301	5-0920-5450	308	0920-99	MISC STREETS	2,500.00	0.00	0.00	2,500.00
TOTAL CAPITAL OUTLAY - EQUIPMENT					441,147.00	14,885.00	3,225.00	423,037.00
TOTAL STREETS					470,147.00	14,885.00	20,373.17	434,888.83
<b>TRAFFIC CONTROL</b>								
CAPITAL OUTLAY - EQUIPMENT								
301	5-0930-5450	308	0930-99	TRAFFIC MISC	0.00	0.00	2,975.00	-2,975.00
TOTAL CAPITAL OUTLAY - EQUIPMENT					0.00	0.00	2,975.00	-2,975.00
TOTAL TRAFFIC CONTROL					0.00	0.00	2,975.00	-2,975.00

**Regular Board of Commissioners**

**4.**

**Meeting Date:** 01/22/2013

Sales Tax

Submitted By: Donna Mayo, Administration

Department: Administration

---

Information

Title of Item for Agenda

Acknowledge Sales Tax report received January 2013.

---

Attachments

Sales Tax

# City of Shawnee Memorandum



**To:** Mayor and City Commissioners  
**CC:** Brian McDougal, City Manager  
**From:** Cynthia R Sementelli, Finance Director  
**Date:** January 16, 2013  
**Re:** City Sales Tax Report

January Sales Tax receipts were down \$21,082 or 1.4%% compared to last year receipts. The January Sales tax amount received plus interest was \$1,470,565 which accumulatively for the fiscal year we are down \$127,665 or 1.32%. Compared to January 2010 figures we were down \$6,259



**CITY OF SHAWNEE  
SALES TAX COLLECTIONS  
Feb 10- Jan 13**

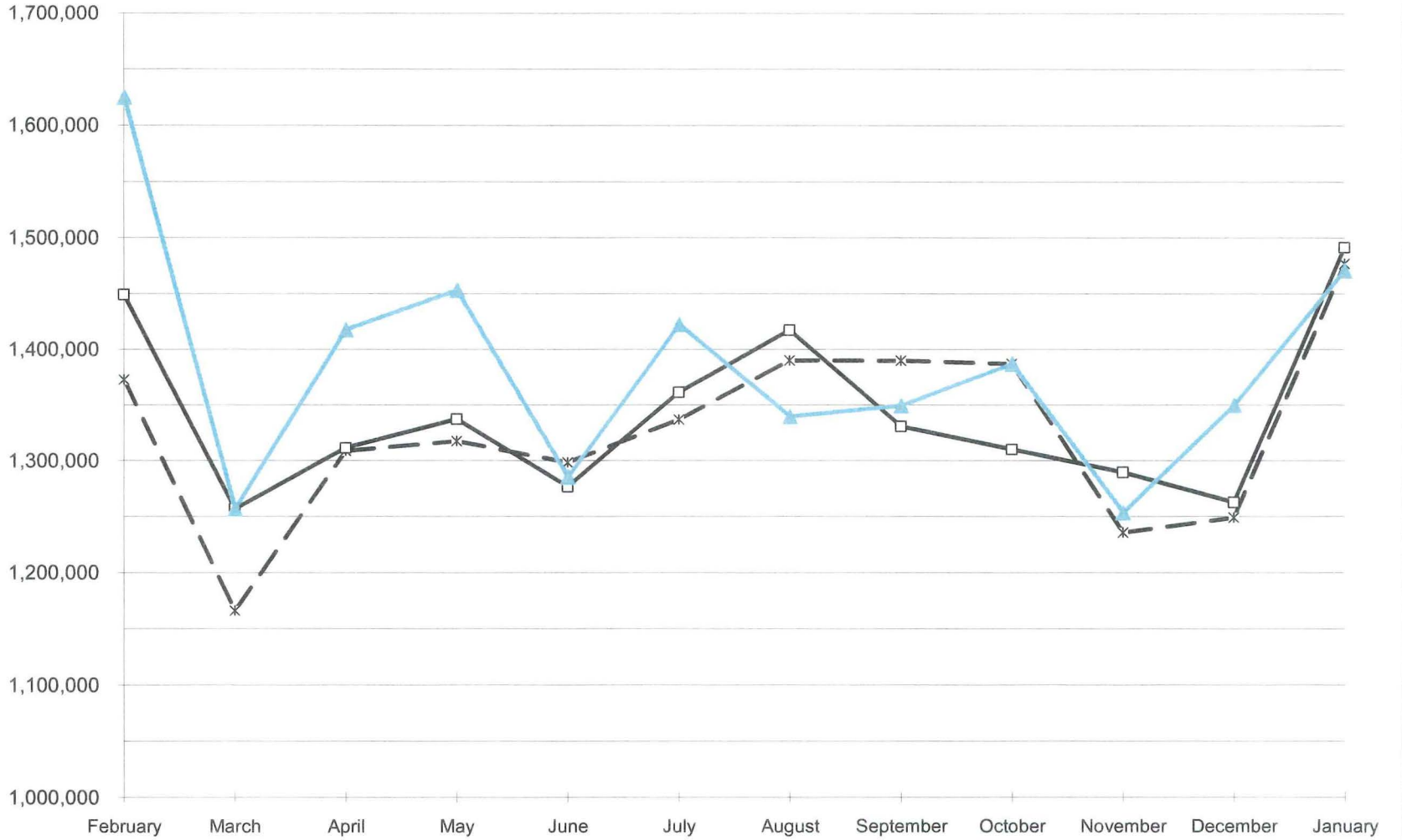

- \*- February 2010 through January 2011
- February 2011 through December 2012
- ▲- February 2012 through January 2013



	February 2010	February 2011	February 2012	Increase (Decrease)	
	through	through	through	Over Prior Year	
Month	January 2011	December 2012	January 2013	Amount	Percentage
February	1,372,608	1,448,966	1,624,568	175,602	12.12%
March	1,165,927	1,256,430	1,256,806	376	0.03%
April	1,308,463	1,311,387	1,417,533	106,146	8.09%
May	1,317,167	1,337,029	1,452,759	115,731	8.66%
June	1,298,026	1,276,542	1,284,872	8,330	0.65%
July	1,336,599	1,361,273	1,422,363	61,090	4.49%
August	1,390,086	1,417,308	1,339,539	(77,769)	(5.49%)
September	1,389,702	1,330,420	1,349,282	18,862	1.42%
October	1,386,987	1,309,924	1,386,657	76,733	5.86%
November	1,235,390	1,289,143	1,253,140	(36,003)	(2.79%)
December	1,248,649	1,262,401	1,349,459	87,058	6.90%
January	1,476,824	1,491,647	1,470,565	(21,082)	(1.41%)
Total	15,926,426	16,092,470	16,607,543	515,073	3.20%
		Prior Year	Current Year	Increase (Decrease)	
Period		Actual	Actual	Over Prior Year	
Fiscal Year to Date		9,462,117	9,571,005	\$108,888	1.15%
Fiscal Year to Date Budget based on last year actual plus 2.5%					
		Current Year	Current Year	Budget Variance	
Period		Budget	Actual	Favorable	(Unfavorable)
Fiscal Year to Date		9,698,670	9,571,005	(\$127,665)	(1.32%)

**Regular Board of Commissioners**

**5.**

**Meeting Date:** 01/22/2013

City Hall Phone System

Submitted By: Donna Mayo, Administration

Department: Administration

---

Information

Title of Item for Agenda

Discussion, consideration and possible action on acceptance of proposal to replace City Hall Phone System and authorize staff to negotiate contract. *Deferred from October 15, 2012 meeting.*

---

Attachments

Phone System

# City of Shawnee Memorandum



**To:** Honorable Mayor and City Commissioners  
**Through:** Brian McDougal, City Manager  
**From:** Donald D. Lynch, Emergency Management Director *D-D.*  
**Date:** January 17, 2013  
**Re:** Proposals to Replace City Hall Telephone System

Following the City Commission direction, Requests for Proposals were solicited from potential vendors. The system requirements requested switching equipment with enough capacity to serve all city locations, cabling and instrument replacement for City Hall and the Annex, and an alternate quote for providing cabling and instrument replacement at the Public Works Service Center. Proposals were received as follows:

Vendor	City Hall & Annex	Public Works	Total
Communications Services	49,641.62	11,785.67	\$61,427.29
CK Telephone	74,299.19	25,523.28	\$99,822.47
Avaya	105,557.80	14,905.20	\$120,463.00
BTC Broadband	117,493.50	6500.74	\$123,994.24
A.O.S.	122,337.35	No Quote	
Stolz Telecom	126,745.00	19,065.00	\$145,810.00
American Telecom			\$162,262.90

A staff committee, consisting of Chief Information Officer Stephen Nolen and his staff, and the Emergency Management Department staff reviewed the proposals submitted and narrowed the field to the proposals from the two potential vendors with the lowest price. We contacted users of the two systems proposed and received favorable recommendations on both. Members of this committee visited locations where equipment was installed and in service.

We contracted with a Certified Public Engineer who has expertise in telephony to review the two proposals and make a recommendation. His recommendation is the solution proposed by CK Telephone based upon the technical perspective. This solution will enhance the potential benefits of competitive bidding for additional telephones in the future and the use of 802.11 based equipment in the solution proposed, will allow wireless infrastructure for both data and telephony.

Therefore staff is recommending and requesting that the proposal from CK Telephone be accepted and that staff be authorized to negotiate a contract for the replacement of the phone systems for both the City Hall and Annex and the Public Works Service Center.

**Regular Board of Commissioners**

**6. a.**

**Meeting Date:** 01/22/2013

Federal Street Bridge Rehab

Submitted By: Donna Mayo, Administration

Department: Administration

---

Information

Title of Item for Agenda

Federal Street Bridge Rehab Project Contract No. COS-PW-12-02 (Award)

*Deferred from January 7, 2013 meeting*

---

Attachments

Memo of Recommendation

Notice to Bidders and Bidders List

<p><b>Mayor</b> WES MAINORD</p> 	<p><b>The City of Shawnee</b> PO Box 1448 Shawnee Oklahoma 74802-1448 (405) 273-1250 Fax (405) 878-1581 <a href="http://www.ShawneeOK.org">www.ShawneeOK.org</a></p>	<p><b>Commissioners</b> PAM STEPHENS LINDA AGEE JAMES HARROD KEITH HALL JOHN WINTERRINGER STEVE SMITH</p>
---	--	---

## M E M O R A N D U M

Date: January 16, 2013

To: Brian McDougal, City Manager

From: John Krywicki, P.E., City Engineer 

**Re: Award of Contract for Fededal Street Bridge Rehab Project  
{Contract No. COS-PW-12-02}**

At the December 17, 2012 City Commission meeting we opened bids that were received for the Federal Street Bridge Rehab Project. The bids have been tabulated and reviewed (see Attached Bid Tabs Contract No. COS-PW-12-02). The lowest and best bid received was from PbX Corporation in the amount of \$665,205.00 for the 'base bid' and \$78,360.00 for the 'add alternate bid items'. The add alternate bid items were to get costs for enhancement features to the bridge structure, and we will explain further at the Commission meeting.

We have thoroughly reviewed the bids and staff would recommend awarding the Project to PbX Corporation in the full amount of the base bid (\$665,205) plus items 1 & 2 of the add alternate bid (\$20,360) for a total bid award of **\$685,565**. Funding for the project will come from our Bridge Maintenance funding accounts which we have budgeted this fiscal year (FY12-13) \$448,357, and with the \$479,958 carried over from last fiscal year (FY11-12) in our Bridge Maintenance accounts, we have a total of \$928,315 available in our Bridge Maintenance funding accounts. Use of this funding in no way will have an effect on our other budgeted and programmed street projects.

If you have any questions or need additional information, please advise.

**BID TABS**

ITEM NO.	Spec No.	DESCRIPTION	QNTY. NO.	UNIT	PBX UNIT PRICE	PBX TOTAL	OBC UNIT PRICE	OBC TOTAL
1.	201A	Clearing & Grubbing	1.00	LSUM	\$ 10,000.00	\$ 10,000.00	\$ 18,750.00	\$ 18,750.00
2.	202A	Unclassified Excavation	150.00	C.Y.	\$ 15.00	\$ 2,250.00	\$ 60.00	\$ 9,000.00
3.	202E	Select Borrow	100.00	C.Y.	\$ 20.00	\$ 2,000.00	\$ 90.00	\$ 9,000.00
4.	619D	Removal of Existing Bridge Structure	1.00	LSUM	\$ 70,000.00	\$ 70,000.00	\$ 90,000.00	\$ 90,000.00
5.	412	Cold Milling Pavement	60.00	S.Y.	\$ 15.00	\$ 900.00	\$ 127.50	\$ 7,650.00
6.	509A	Class AA Concrete	100.00	C.Y.	\$ 1,200.00	\$ 120,000.00	\$ 940.00	\$ 94,000.00
7.	511B	Epoxy Coated reinforcing Steel	40,000.00	LB	\$ 1.30	\$ 52,000.00	\$ 0.90	\$ 36,000.00
8.	507C	Elastomeric Bearing Pads	24.00	EA.	\$ 1,500.00	\$ 36,000.00	\$ 565.00	\$ 13,560.00
9.	502	Falsework Jacking	1.00	LSUM	\$ 10,000.00	\$ 10,000.00	\$ 174,400.00	\$ 174,400.00
10.	504E	Parapet	230.00	LF	\$ 130.00	\$ 29,900.00	\$ 145.00	\$ 33,350.00
11.	624	Wrought Iron Fence (5')	230.00	LF	\$ 75.00	\$ 17,250.00	\$ 127.50	\$ 29,325.00
12.	504A	Approach Slab	115.00	S.Y.	\$ 225.00	\$ 25,875.00	\$ 190.00	\$ 21,850.00
13.	609B	Combined Curb & Gutter	90.00	LF	\$ 35.00	\$ 3,150.00	\$ 105.00	\$ 9,450.00
14.	509	Preformed Expansion Joint Filler	120.00	LF	\$ 10.00	\$ 1,200.00	\$ 15.00	\$ 1,800.00
15.	504G	Rapid Cure Joint Sealant	105.00	LF	\$ 12.00	\$ 1,260.00	\$ 60.00	\$ 6,300.00
16.	501G	CSLM Backfill	40.00	CY	\$ 250.00	\$ 10,000.00	\$ 270.00	\$ 10,800.00
17.	512A	Cleaning and Painting Existing Structure	1.00	LSUM	\$ 10,000.00	\$ 10,000.00	\$ 8,250.00	\$ 8,250.00
18.	521A	Pneumatically Placed Mortar	30.00	S.Y.	\$ 734.00	\$ 22,020.00	\$ 1,000.00	\$ 30,000.00
19.	701	Fiber Wrapping (carbon)	50.00	LSUM	\$ 103.00	\$ 5,150.00	\$ 140.00	\$ 7,000.00
20.	510C	Slopewall (4")	260.00	S.Y.	\$ 160.00	\$ 41,600.00	\$ 185.00	\$ 48,100.00
21.	511A	Reinforcing Steel	120.00	LB	\$ 1.00	\$ 120.00	\$ 2.00	\$ 240.00
22.	221C	Temporary Silt Fence	150.00	LF	\$ 4.00	\$ 600.00	\$ 16.50	\$ 2,475.00
23.	855A	Traffic Stripe (Plastic) (4" wide)	310.00	LF	\$ 3.00	\$ 930.00	\$ 3.60	\$ 1,116.00
24.	880J	Construction Traffic Control	1.00	LSUM	\$ 10,000.00	\$ 10,000.00	\$ 2,730.00	\$ 2,730.00
25.	641	Mobilization	1.00	LSUM	\$ 75,000.00	\$ 75,000.00	\$ 81,500.00	\$ 81,500.00
26.	104	Railroad Access Expences	1.00	LSUM	\$ 2,000.00	\$ 2,000.00	\$ 63,000.00	\$ 63,000.00
27.		>Flagger	90.00	PD	\$ 800.00	\$ 72,000.00	\$ 2,400.00	\$ 216,000.00
28.		>Insurance	1.00	LSUM	\$ 34,000.00	\$ 34,000.00	\$ 12,900.00	\$ 12,900.00
<b>TOTAL AMOUNT OF BASE BID</b>						<b>\$ 665,205.00</b>	<b>\$ 1,038,546.00</b>	

**ALTERNATIVE BID ITEMS**

ITEM	DESCRIPTION	QNTY NO.	UNIT	UNIT PRICE	TOTAL	UNIT PRICE	TOTAL
1.	510 Parapet Form Liner	290	SY	\$ 25.00	\$ 7,250.00	\$ 85.00	\$ 24,650.00
2.	510 Stain and Sealant Application	690	SY	\$ 19.00	\$ 13,110.00	\$ 65.00	\$ 44,850.00
3.	502 Column	4	EA	\$ 14,500.00	\$ 58,000.00	\$ 7,850.00	\$ 31,400.00
<b>TOTAL ALTERNATIVE BID</b>					<b>\$ 78,360.00</b>	<b>\$ 100,900.00</b>	

CITY OF SHAWNEE  
CAPITAL OUTLAY BUDGET REPORT

FY 12-13

FUND	ACCOUNT	PROJECT	LINE	DESCRIPTION	BUDGET	ACTUAL	ENCUMBRANCES	BALANCE
<u>STREET IMPROVEMENT FUND</u>								
PLANNING - OLB DO NOT USE								
CAPITAL OUTLAY - STREETS								
302	5-0520-5480	308	0810-13	BRYAN & INDEPENDANCE	198,562.60	0.00	0.00	198,562.60
302	5-0520-5480	308	0810-14	HARRISON STREET PLANTER	98,624.00	0.00	0.00	98,624.00
TOTAL CAPITAL OUTLAY - STREETS					297,186.60	0.00	0.00	297,186.60
TOTAL PLANNING - OLB DO NOT USE					297,186.60	0.00	0.00	297,186.60
ENGINEERING								
CAPITAL OUTLAY-BLDGS/IMPRV								
302	5-0810-5420	308	0810-10	BELL STREET ENAHANCEMENT	180,000.00	0.00	81000.00	99,000.00
302	5-0810-5420	308	0810-11	ADA HANICAP RAMPS AND SIDEWALK	200,000.00	52,550.79	0.00	147,449.21
302	5-0810-5420	308	0810-12	BRIDGE MAINT	450,000.00	1,613.00	0.00	448,387.00
302	5-0810-5420	308	0850-03	REPAIR AND MAINT MATERIAL	150,000.00	394.00	0.00	149,606.00
TOTAL CAPITAL OUTLAY-BLDGS/IMPRV					980,000.00	54,557.79	81000.00	925,442.21
TOTAL ENGINEERING					980,000.00	54,557.79	81000.00	925,442.21
NEW STREET PROJECTS								
CAPITAL OUTLAY - STREETS								
302	5-0820-5480	308	0810-13	BRYAN & INDEPENDANCE	198,562.60	74,324.01	130,675.89	4,562.70
302	5-0820-5480	308	0810-15	KULHBIRD LANE HAZARD MITIGATION	54,211.30	0.00	0.00	54,211.30
302	5-0820-5480	308	0850-06	FY 11-12 REHAB PROJECT	589,090.00	115,718.98	473,371.02	0.00
TOTAL CAPITAL OUTLAY - STREETS					841,863.90	190,043.09	604,046.91	54,774.00
CAPITAL OUTLAY - KICKAPOO ST								
302	5-0820-5481	308	0820-01	KICKAPOO	3,090,000.00	2,150,715.98	0.00	939,284.02
TOTAL CAPITAL OUTLAY - KICKAPOO ST					3,090,000.00	2,150,715.98	0.00	939,284.02
TOTAL NEW STREET PROJECTS					3,931,863.90	1,340,759.07	604,046.91	987,058.02



# CITY OF SHAWNEE CAPITAL OUTLAY BUDGET REPORT

FY 11-12

FUND	ACCOUNT	PROJECT	LINE	DESCRIPTION	BUDGET	ACTUAL	ENCUMBRANCES	BALANCE
OTHER PROJECTS								
CAPITAL OUTLAY - BLDGS/IMPRV								
302	5-0880-5420	208	0810-02	ADA SIDEWALK	150,000.00	15,140.99	0.00	134,859.01
		TOTAL	CAPITAL OUTLAY - BLDGS/IMPRV		150,000.00	15,140.99	0.00	134,859.01
CAPITAL OUTLAY - STREETS								
302	5-0880-5480	208	0810-06	REPAIR AND MAINTENANCE MATERIA	150,000.00	69,907.37	27,892.99	52,199.64
302	5-0880-5480	208	0810-12	ASHPALT REHAB PROJECT-ROLLOVE	1,135,445.00	0.00	24,500.00	1,110,945.00
302	5-0880-5480	208	0810-16	DESIGN FOR CITY BRIDGES-ROLLOY	12,526.75	10,650.00	580.00	1,296.75
302	5-0880-5480	208	0810-17	EXPO PARKING LOT	0.00	13.00	0.00	-13.00
302	5-0880-5480	208	0820-01	NEW STREETS	0.00	0.00	0.00	0.00
302	5-0880-5480	208	0850-02	REHAB CONCRETE STREETS	350,000.00	71,307.14	0.00	278,692.86
302	5-0880-5480	208	0880-01	BRIDGE MAINT 09-10	250,815.00	0.00	250,815.00	0.00
302	5-0880-5480	208	0880-02	BRIDGE MAINT 10-11	287,300.00	0.00	287,300.00	0.00
302	5-0880-5480	208	0880-03	BRIDGE MAINT 11-12	600,000.00	192,332.12	407,645.88	0.00
		TOTAL	CAPITAL OUTLAY - STREETS		2,786,586.75	344,232.63	999,243.87	1,443,110.25
		TOTAL	OTHER PROJECTS		2,936,586.75	359,372.62	999,243.87	1,577,870.26
STREETS								
CAPITAL OUTLAY - STREETS								
302	5-0920-5480	208	0810-06	REPAIR AND MAINTENANCE MATERIA	150,000.00	12,630.06	12,413.94	124,956.00
302	5-0920-5480	208	0810-11	MALL DRIVE COS-PW-10-01 ROLL	0.00	51,732.48	0.00	-51,732.48
		TOTAL	CAPITAL OUTLAY - STREETS		150,000.00	64,362.54	12,413.94	73,217.52
		TOTAL	STREETS		150,000.00	64,362.54	12,413.94	73,217.52

-\$1,138,615

# SCHEDULE OF PAYMENTS

P.O. 12-2219

## PbX CORPORATION LAKE ROAD BRIDGE REHABILITATION PROJECT

COS-PW-11-03

DATE	PAY REQUEST	AMOUNT	BALANCE	APPROVED FOR PAYMENT
02/10/12	<del>ENROLLMENT</del> <b>CONTRACT BID</b> →	\$ 630,316.30		*****
02/17/12	#1 (1)	\$ 21,309.93	\$ 609,006.37	<u>JMK</u>
03/09/12	#2 (2)	\$ 69,299.82	\$ 539,706.55	<u>JMK</u>
03/12/12	#3 (3)	\$ 101,744.37	\$ 437,962.18	<u>JMK</u>
05/22/12	#4 (4)	\$ 76,249.48	\$ 361,712.70	<u>JMK</u>
05/22/12	#5 (5)	\$ 102,252.74	\$ 259,459.96	<u>JMK</u>
06/28/12	#6 (6)	\$ 98,076.51	\$ 161,383.45	<u>JMK</u>
06/28/12	#7 (7)	\$ 32,435.28	\$ 128,948.17	<u>JMK</u>
06/28/12	#8 (8)	\$ 33,073.74	\$ 95,874.43	<u>JMK</u>
06/28/12	#9 (9)	\$ 80,597.23	\$ 15,277.20	<u>JMK</u>

**TOTAL PAID**

**TO DATE: \$ 615,039.10**

\*\*PO was actually opened for \$1,138,615.00 by mistake. Only \$630,316.30 is needed for this project.\*\*



CITY OF SHAWNEE

16 W 9TH St / PO BOX 1848
SHAWNEE OK 74802-1848
(405) 878-1652 or (405) 878-1611
www.ShawneeOK.org

PURCHASE ORDER

PO NUMBER: 12-2219

Page: 1

This PO Number must appear on all invoices and correspondence

Vendor# 01-2523

Req # 1044208

Issue Date: 2/10/2012

Vendor:

PBX CORPORATION
P O BOX 644
SAPULPA, OK 74067

Phone:

(918) 227-9650

Fax :

(918) 227-9637

Ship To:

ENGINEERING DEPT
222 NORTH BROADWAY
SHAWNEE OK 74801

Table with 5 columns: UNITS, DESCRIPTION, G/L ACCOUNT, UNIT PRICE, TOTAL PRICE. Rows include COS-PW-11-03 for periods 09-10, 10-11, 11-12 and a summary row for 'WORK PERFORMED ON LAKE ROAD BRIDGE REHAB PROJECT'.

Handwritten red notes: \$479,950 -> fund amount, 100% unallocated.

Handwritten blue notes: 6/15/09/10, 6/28/12

DEPARTMENT COPY

TERMS AND CONDITIONS

Purchaser is exempt from Federal and Stat Tax. EIN #: 73-6005424

State law requires the vendor to furnish an itemized invoice which states the vendor's name and address, a clear description of each item purchased, its unit price, the number or volume of each item, its total price, the total amount of the purchase and the date of the purchase.

For purchases of \$1,000 or more a notarized non-collusion affidavit must accompany the invoice.

Show Purchase Order Number on all documents.

Enclose Packing Slip with each shipment.

Mail Invoices to: CITY OF SHAWNEE
PO BOX 1848

POB: 510/21 09/2009 SHAWNEE OK 74802 4848



TOTAL

1,138,615.00

CITY OF SHAWNEE

AUTHORIZED BY

Handwritten signature

Authorized Signature



Mayor  
WES MAINORD



**The City of Shawnee**  
PO Box 1448  
Shawnee Oklahoma 74802-1448  
(405) 878-1760 Fax (405) 878-1719  
[www.ShawneeOK.org](http://www.ShawneeOK.org)

**Commissioners**  
PAMELA STEPHENS  
LINDA AGEE  
JAMES HARROD  
KEITH HALL  
JOHN WINTERINGER  
STEVE SMITH

December 5, 2012

Re: Federal Street Bridge Rehabilitation; Pre-bid Meeting Bid Item Alternatives

Note to contractors:

Alternative bid items will be added to the Federal Street Bridge Rehabilitation Project by means of an addendum. Those items are to include:

1. A column with dimensions of 2'x2'x8' and footing with a stone *façade*. Stones to be used are Texas White and Arkansas Pencil stone (the ones used on the City of Shawnee sign located at the new planter just south of Harrison Street and I-40). Exact dimensions will be submitted with the addendum.
2. A form liner design incorporated during the pouring of the new parapet. The design will be *Old Ashlar Stone* from Dayton Superior or equivalent. The exact dimensions and placement will be included in addendum.
3. Staining of the parapets and headwall. The colors of the stain will be determined at a later date but will consist of three colors and a matte finish stain.

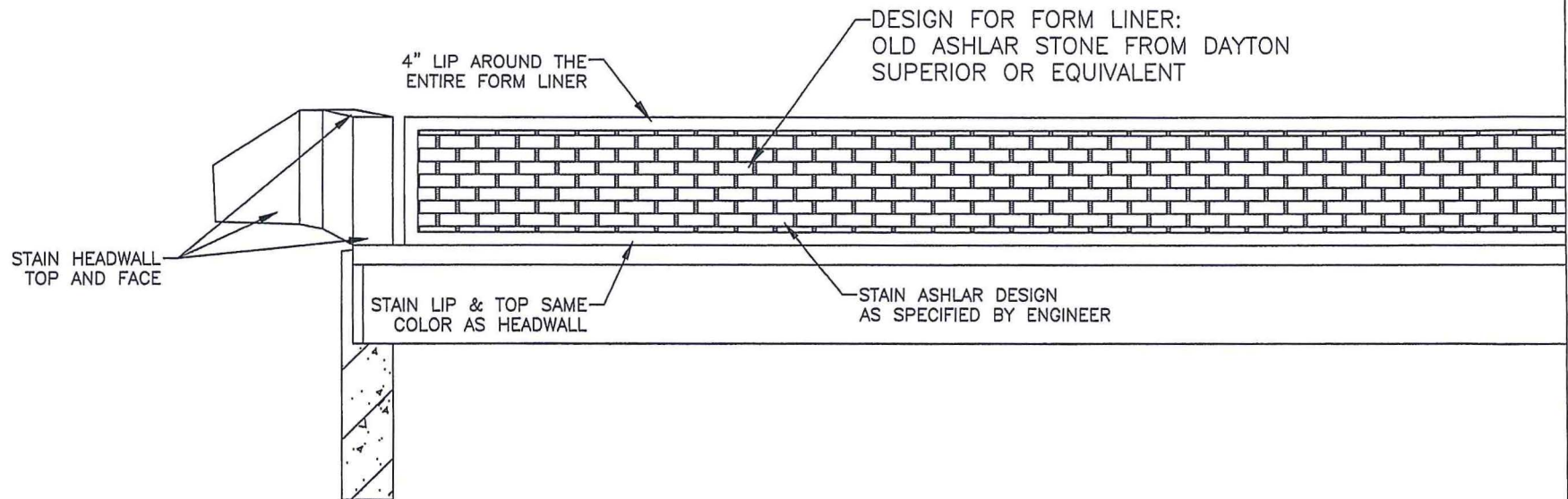

A:\Documents\171\Projects\12\12-02-Federal Street Bridge Rehabilitation\Drawings\12-02-Federal Street Bridge Rehabilitation.dwg

FEDERAL STREET BRIDGE REHABILITATION ALTERNATIVE: PARAPET FORM & STAIN			
DESIGNED BY	DATE	CITY OF SHAWNEE 222 BROADWAY SHAWNEE, OKLAHOMA	
CHECKED BY	DATE		
ENGINEER	DATE	ENGINEERING DEPARTMENT	
DRAWN BY	DATE	SCALE	PROJECT NO.
	10/01/12	1/8" = 1'-0"	002-PR-12-02
			SHEET NO.
			AT



# Old Ashlar Stone

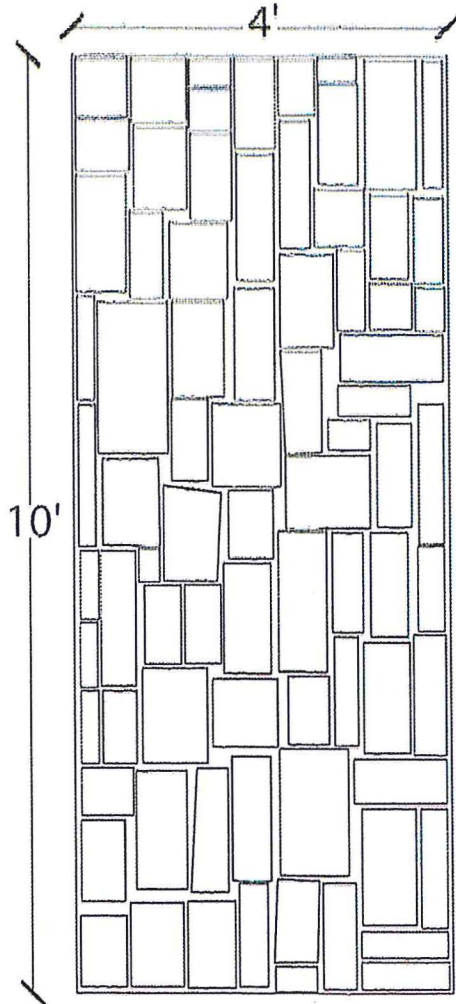

### General Information:

The Styrene and ABS form liners are an economical solution for providing architectural pattern reproductions. The Styrene plastic form liner is a perfect alternative for single use applications which costs less than other liners. The ABS plastic form liner exhibits good impact resistance and excellent overall performance. Its reuse factor is 10, subject to pattern configuration, proper handling and jobsite configurations.

### Care and Handling:

To protect from thermal deformation, form liners should not be exposed to temperatures above 140°F (60°C). To avoid discoloration from sunlight exposure, form liners should be covered with a tarpaulin when not in use. This helps prolong the life of the material and keeps the material clean.

Form Liners are subject to thermal expansion and contraction +/- 1/8" @ 70°F. Keep away from steam, acids, and certain fuels.

Styrene	ABS
Product Code #	Product Code #
F30429	F30427
Uses	Uses
1	Up to 10
Material Thickness	Material Thickness
.090	.110
Standard Dimensions	Standard Dimensions
10' x 4'	10' x 4'
Color	Color
White	Gray



FORM LINER TECHNICAL SERVICE 210-648-6100  
1155 Church Hill Drive, New Braunfels, TX 78130

At Engineers/Civil/Project/Street Bridge Rehabilitation/Project # Bridge Rehabilitation

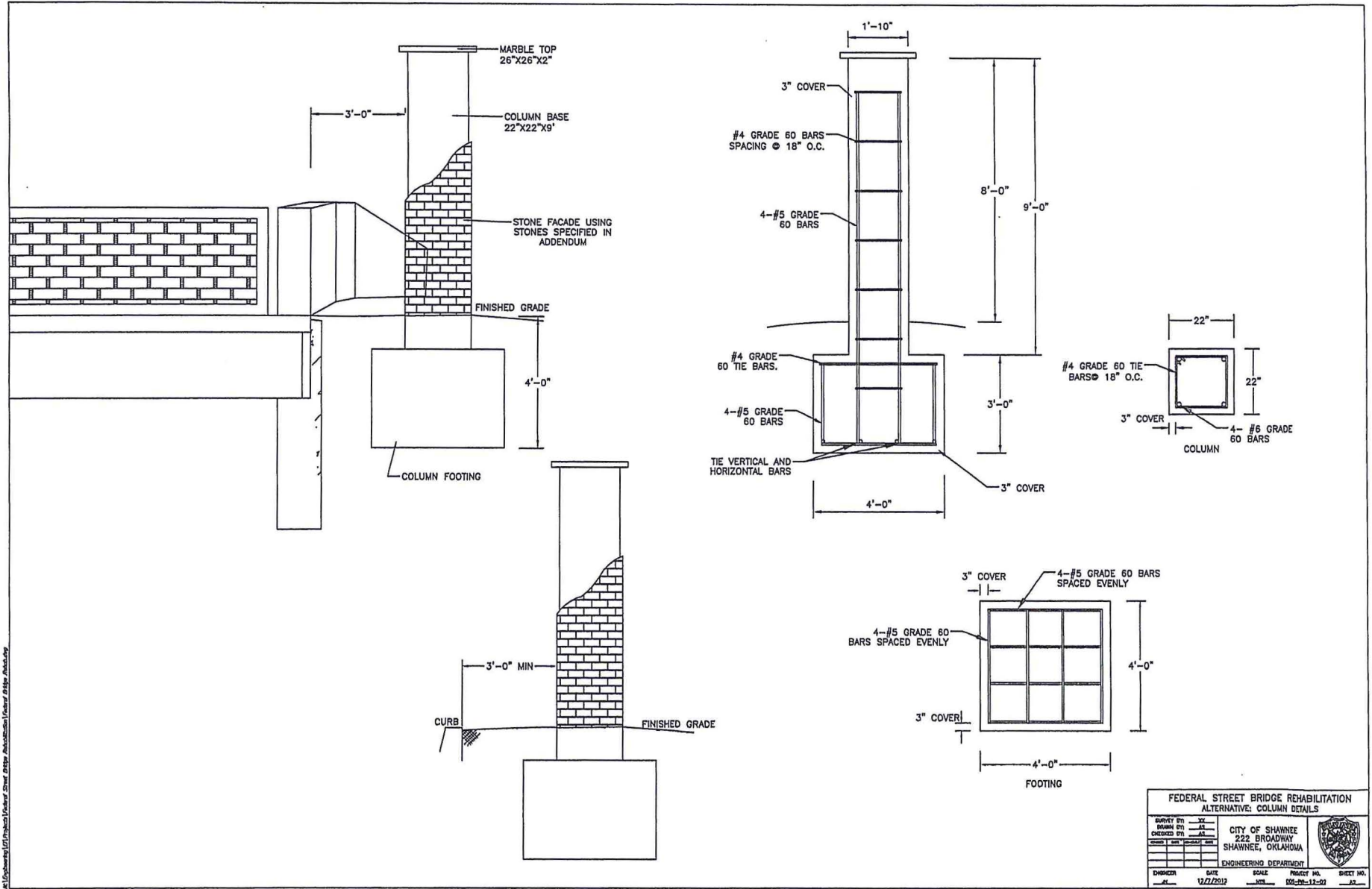

FEDERAL STREET BRIDGE REHABILITATION ALTERNATIVE: COLUMN DETAILS			
DRAWN BY JC	CITY OF SHAWNEE 222 BROADWAY SHAWNEE, OKLAHOMA		SHEET NO. 02
CHECKED BY JC	ENGINEERING DEPARTMENT		
DESIGNED BY JC	DATE 12/7/2013	SCALE 1/4" = 1'-0"	PROJECT NO. 000-PRJ-112-01



CITY OF  
*Shawnee*  
EST. 1894



City of Shawnee  
Bridge Preservation Plan  
Appendix A – Bridge 7 Field Assessment



## General Bridge Information

### Bridge Location

County: Pottawatomie  
City: Shawnee  
Facility Carried: FAU5510 (Federal Street)  
Crossing Feature: A.T. & S.F. Railroad  
NBI No.: 17876  
Local ID: 7  
Bridge Description: 35' - 45' - 35' Span PC Beam Bridge w/ Concrete Rails

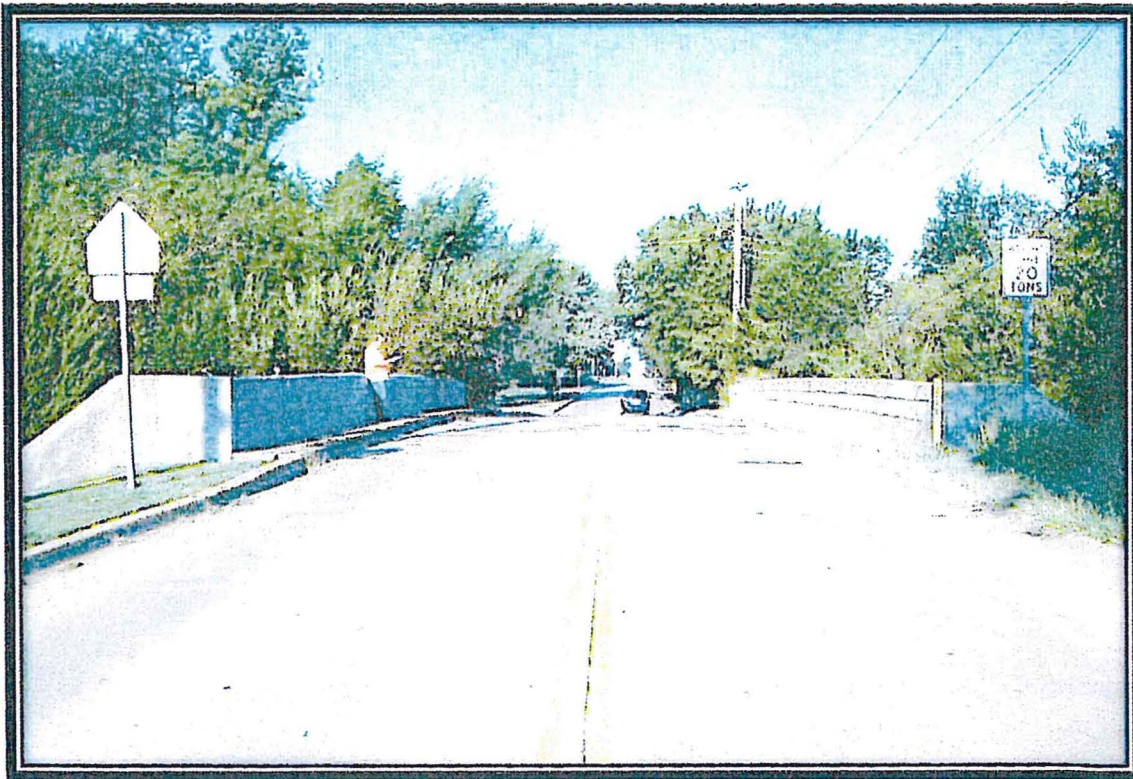

Looking West along the deck.

City of Shawnee  
Bridge Preservation Plan  
Appendix A – Bridge 7 Field Assessment



Preliminary Estimate – \$632,411

**Improvement Types(s)** (place x by all applicable types)

- X Deck Replacement: **Replace entire deck and traffic rails**
- Deck Rehabilitation:
  - 5" Concrete Overlay
  - Overlay
- Description:
  - Flood Coat
  - Superstructure Replacement
- Painting:
- Joint Repair:
- X Beam Repair: **Grout/Repair Beam ends**
- X Bearing Repair:
- X Sub-structure Repair: **Patch Pier Caps**
- X Scour Repair: **Concrete slopewall with backfill at the abutment headers.**
- Other Major Action(s)
  - Description:

Description of Traffic

The bridge will be closed to traffic. A minimal detour route is required to maintain access to side streets on the east and west sides of the bridge.

Description of Utilities

A water line hangs from the overhang section of the deck on the south side of the bridge. A communication/power line hangs from the overhang section of the deck on the North side of the bridge. The bridge is over a railroad, so a permit to work will be required as well as coordination with the railroad during construction.

City of Shawnee  
Bridge Preservation Plan  
Appendix A – Bridge 7 Field Assessment



## Photo Documentation

### Bridge Element: Deck

#### Existing Condition:

The deck slab contains patches, potholes, and impending potholes. A 3 foot by 3 foot patch is visible in the soffit. A chain drag indicated many more delaminations not yet fully formed into spalls and potholes.

#### Proposed Improvements:

Replace deck slab and traffic rail with current design. Install an approach slab and expansion joint on the West side of the bridge.



Condition of the Deck

City of Shawnee  
Bridge Preservation Plan



Appendix A - Bridge 7 Field Assessment

Bridge Element: Prestressed Beam Ends and Diaphragms

Existing Condition:

The beam ends at the piers are cracking and spalling.

Proposed Improvements:

Clean exposed rebar and grout cracked and broken beam ends.



Typical Condition of Fascia Beam Ends over Piers.

City of Shawnee  
Bridge Preservation Plan



Appendix A – Bridge 7 Field Assessment

Bridge Element: Abutment Headers

Existing Condition:

Erosion has exposed the abutment piles.

Proposed Improvements:

Install sloped wall to arrest erosion and cover piles.



Erosion at East Abutment, West is similar

# City of Shawnee Bridge Preservation Plan



## Appendix A – Bridge 7 Field Assessment

### Bridge Element: Pier Caps & Pier Walls

Existing Condition: The pier caps are spalling and rebar is exposed.

Proposed Improvements: Place pneumatic mortar to patch pier caps.



Spalling and Staining on Pier Cap

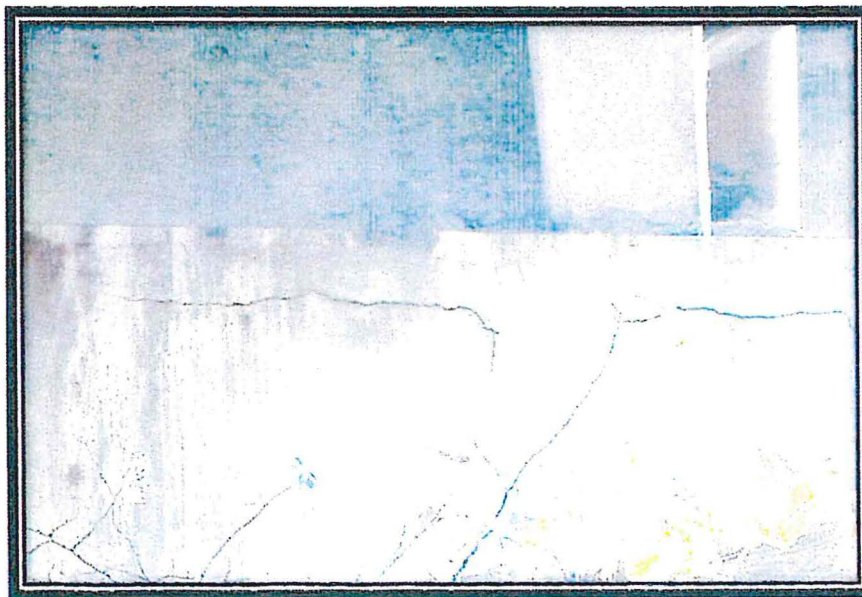

Cracks on West Pier Cap

# FEDERAL STREET BRIDGE REHABILITATION

LOCATION:  
ON FEDERAL STREET OVERPASSING  
BNSF RAILROAD TRACKS

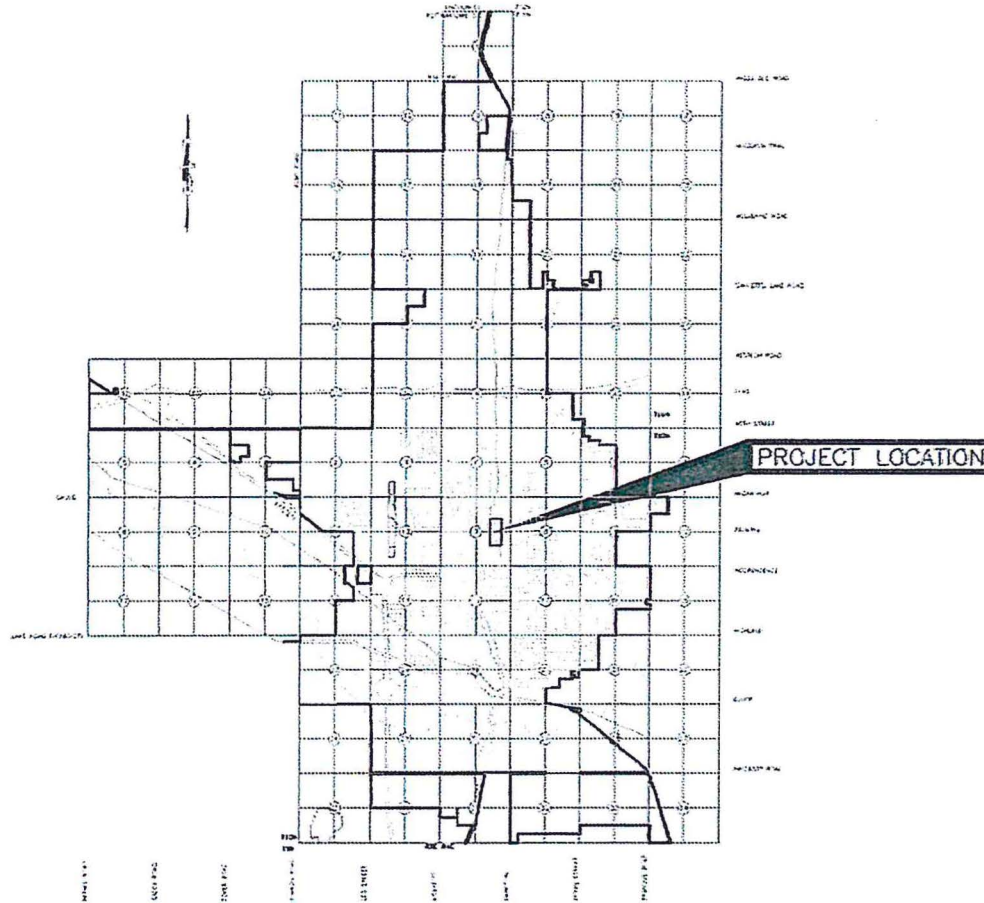

COS-PW-12-02

# THE CITY OF SHAWNEE

**WES MAINORD**  
MAYOR

**PAMELA STEPHENS**  
CITY CLERK

**JAMES HARRJOE**  
CITY CLERK

**JOHN WINTERRINGER**  
CITY CLERK

**LINDA AGEE**  
CITY CLERK

**KEITH HALL**  
CITY CLERK

**STEVE SMITH**  
CITY CLERK

**BRIAN McDOUGAL**  
CITY MANAGER

**PHYLLIS LOFTIS**  
CITY CLERK

**CYNTHIA SEVENTELLI**  
CITY TREASURER

## SHEET INDEX

SHEET NO.	DESCRIPTION
1	FIELD SHEET
2	GENERAL NOTES
3	PLAN VIEW
4	PLAN VIEW (BRIDGE) WITH
5	SECTIONAL SHEET
6	SECTIONAL SHEET
7	CONSTRUCTION NOTES
8	CONSTRUCTION NOTES
9	PLAN AND ELEVATION
10	SECTIONAL SHEET
11	SECTIONAL SHEET

## UTILITY LOCATION NUMBERS

STATEWIDE 1-800-874-5441  
OKLAHOMA STATE 1-800-874-5441  
LOCAL 1-800-874-5441

## ENGINEERING DEPARTMENT

APPROVED AS FINAL

DIVISION

CITY ENGINEER

CITY CLERK

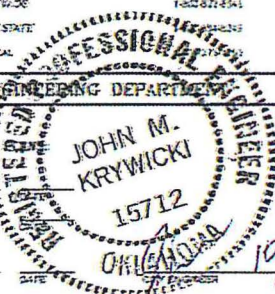

DATE 10/30/12



## GENERAL NOTES

### GENERAL CONSTRUCTION NOTES

THIS PROJECT SHALL BE CONSTRUCTED BY CLOSING FEDERAL STREET BRIDGE TO ALL TRAFFIC. SEE STANDARD SPECIFICATIONS FOR MAINTENANCE OF LOCAL AND THROUGH TRAFFIC. REMOVED MATERIAL IS TO BECOME PROPERTY OF THE CONTRACTOR AND IT SHALL BE DISPOSED OF IN A MANNER APPROVED BY THE ENGINEER. ALL TEMPORARY TRAFFIC CONTROL DEVICES SHALL MEET ODOT'S "QUALITY STANDARDS FOR TEMPORARY TRAFFIC CONTROL DEVICES".

### SPECIFICATIONS

COMPLY WITH THE REQUIREMENTS OF THE 2009 OKLAHOMA STANDARD SPECIFICATIONS FOR HIGHWAY CONSTRUCTION, EXCEPT AS MODIFIED BY THE PLANS AND SPECIAL PROVISIONS.

### DESCRIPTION OF WORK

THIS PROJECT CONSISTS OF THE REHABILITATION OF AN EXISTING STRUCTURE BY THE REMOVAL AND REPLACEMENT OF EXISTING DECK, APPROACH, SIDEWALKS, BEARINGS AND PARAPETS AS WELL AS MAKING REPAIRS TO THE EXISTING SUBSTRUCTURE AND SUPERSTRUCTURE AND INSTALLATION OF A SLOPE WALL ON EITHER SIDE OF THE BRIDGE. THESE SHALL BE IN ACCORDANCE WITH THE 2009 STANDARD SPECIFICATIONS, SPECIAL PROVISIONS, DETAIL PLANS SHEETS AND NOTES. FALSEWORK MAY BE USED AS LONG AS CONSTRUCTION CLEARANCES SPECIFIED IN PLANS ARE MET.

### VERIFICATION OF EXISTING CONDITIONS

BIDDERS SHALL FULLY INFORM THEMSELVES OF THE EXISTING CONDITIONS AND ANY POTENTIAL HAZARDS UNDER WHICH THE CONSTRUCTION WILL BE PERFORMED. THE CONTRACTOR SHALL ADOPT METHODS CONSISTENT WITH GOOD CONSTRUCTION PRACTICE AND SHALL TAKE ALL NECESSARY PRECAUTIONS TO PREVENT DAMAGE TO THE EXISTING BRIDGE STRUCTURES, ROADWAY SURFACES, STRIPING, GUARDRAIL, SLOPES, SIGNS, ETC.

CONTRACTOR SHALL TAKE PRECAUTIONS TO MAINTAIN THE INTEGRITY OF ALL EXISTING UTILITIES. UTILITY COMPANY INFORMATION HAS BEEN PROVIDED, BUT IT IS THE CONTRACTOR'S RESPONSIBILITY TO VERIFY ALL LOCATIONS AND COORDINATE WITH UTILITY COMPANIES IF REQUIRED. ALL DIMENSIONS AND LOCATIONS OF EXISTING COMPONENTS SHOWN ON THE PLANS ARE APPROXIMATE.

ANY DAMAGE TO THESE EXISTING ITEMS DURING CONSTRUCTION SHALL BE REPAIRED AND/OR REPLACED AT THE CONTRACTOR'S EXPENSE TO THE ENGINEER'S SATISFACTION.

### UTILITY CONTACTS:

OG&E	KEN ECHARD	(405)553-5785
OG&E	(BEFORE DUG)	(800)522-6543
OG&E	[EMERGENCY]	(800)548-4251
CITY OF SHAWNEE (ENG)	JOHN KRYWICKI	(405)878-1760
CITY OF SHAWNEE (WATER)	JIM BIERD	(405)878-1513
BIGF	KAME MINOR	(913)551-4484

### PLANS

THE ORIGINAL PROJECT PLANS WILL BE INCLUDED WITH THE BID DOCUMENTS FOR THIS PROJECT.

### WORK SITE OBSTRUCTIONS

ALL OBSTRUCTIONS, INCLUDING VEGETATION AND DEBRIS, INTERFERING WITH ANY DEMOLITION OR CONSTRUCTION ACTIVITIES BEING PERFORMED SHALL BE REMOVED BY THE CONTRACTOR PRIOR TO BEGINNING WORK. ALL COSTS ASSOCIATED WITH REMOVAL OF OBSTRUCTIONS SHALL BE INCLUDED IN "CLEARING AND GRUBBING" ITEM.

### REMOVE AND RESET SIGNS

ANY EXISTING SIGNS CONFLICTING WITH THE CONSTRUCTION SHALL BE REMOVED, STORED, AND RESET AS NECESSARY. ANY DAMAGED SIGNS SHALL BE REPLACED AT THE EXPENSE OF THE CONTRACTOR.

ALL COST OF REMOVING, STORING, AND RESETTING SIGNS INCLUDING COST OF MATERIALS, LABOR, EQUIPMENT AND INCIDENTALS SHALL BE INCLUDED IN OTHER ITEMS OF WORK.

### CLEANING PIER CAPS

ALL DEBRIS FROM THE PIER CAPS AND COLUMNS BEING REPAIRED SHALL BE REMOVED AND BECOME THE PROPERTY OF THE CONTRACTOR AND WILL BE DISPOSED OF IN A MANNER APPROVED BY THE ENGINEER. ALL COST OF CLEANING THE PIER CAPS AND COLUMNS SHALL BE PAID FOR IN OTHER ITEMS OF WORK.

### APPROACHES

THE EXISTING APPROACH IS TO BE COMPLETELY REMOVED AND CONSTRUCTED TO GRADE FOR SMOOTH TRANSITION FROM ROADWAY TO BRIDGE WITH CONCRETE PER THESE PLANS. ALL REMOVED MATERIALS SHALL BE THE PROPERTY OF THE CONTRACTOR AND TO BE DISPOSED OF IN A MANNER APPROVED BY THE ENGINEER.

ALL COSTS TO REMOVE THE EXISTING CONCRETE APPROACH INCLUDING LABOR, MACHINERY AND MATERIALS WHICH THE EXCEPTION OF MILLING THE EXISTING ASPHALT PAVEMENT SHALL BE INCLUDED IN THE PRICE BID FOR "REMOVAL OF BRIDGE STRUCTURAL ITEMS". COLD MILLING THE EXISTING ASPHALT IS A SEPARATE BID ITEM.

TO REPLACE THE CONCRETE APPROACH, IT IS TO BE BID AS A UNIT PRICE PER SQUARE YARD NOT CUBIC YARD. IF THE EXISTING APPROACH IS THICKER THAN ANTICIPATED, THE EXTRA EXPENSE WILL BE THE RESPONSIBILITY OF THE CONTRACTOR TO BRING THE APPROACH TO GRADE. THE CONTRACTOR SHALL COMPACT CLSM WHERE VOIDS EXIST UNDERNEATH THE NEWLY CONSTRUCTED APPROACH.

### REMOVAL OF BRIDGE STRUCTURAL ITEMS

PAY ITEM "REMOVAL OF BRIDGE STRUCTURAL ITEMS" CONSISTS OF COMPLETE REMOVAL OF THE APPROACHES, DECK SLAB, SIDEWALK, AND PARAPETS. ALL REMOVAL MUST BE DONE IN A FASHION TO NOT DAMAGE THE EXISTING STRUCTURE, PROTRUDING REINFORCING STEEL, RAILROAD TRACKS BELOW, AND ANY OTHER OBJECTS THAT MAY INTERFERE. IF DAMAGED, THE EXPENSE WILL BE THE CONTRACTOR'S RESPONSIBILITY. ALL ITEMS MUST BE DISPOSED OF IN A MANNER THAT IS APPROVED BY THE ENGINEER.

### PARAPETS

THE EXISTING PARAPETS WILL BE REMOVED AND REPLACED ON THE ENTIRE LENGTH OF THE BRIDGE. STANDARDS FOR THE PARAPETS HAVE BEEN PROVIDED IN THESE PLANS.

ALL COST TO REPLACE THE PARAPETS WILL BE INCLUDED IN THE BID ITEM "PARAPET" AND WILL BE DONE IN ACCORDANCE TO ODOT SPECIFICATIONS.

### SLOPE WALL

A SLOPE WALL WITH FOOTING SHALL BE CONSTRUCTED ON BOTH SIDES OF THE RAILROAD TRACK BENEATH THE BRIDGE STRUCTURE AND IS TO BE CONNECTED TO THE ABUTMENT WITH REINFORCING STEEL AND EPOXY. IT SHALL BE BUILT ACCORDING TO THESE PLANS AND ODOT'S SPECIFICATIONS DESCRIBED IN SECTION 510. ALL COSTS TO COMPLETE THE WORK INCLUDING THE COST OF MATERIAL, LABOR, EQUIPMENT AND INCIDENTALS SHALL BE INCLUDED IN THE BID ITEM FOR "SLOPE WALL (\*)".

### ELASTOMERIC BEARING PADS

THE EXISTING ELASTOMERIC BEARING PADS SHALL BE REPLACED DIRECTLY BETWEEN THE BOTTOM OF THE BEAM AND TOP OF THE PIER CAP. ALL COSTS INCLUDING LABOR, COSTS, EQUIPMENT AND INCIDENTALS ARE INCLUDED IN THE BID ITEM "ELASTOMERIC BEARING PADS". ANY DAMAGE DONE TO THE EXISTING STRUCTURE SHALL BE REPAIRED TO THE ENGINEER'S APPROVAL AT THE CONTRACTOR'S EXPENSE.

### CLEARING AND GRUBBING

THE CLEARING AND GRUBBING OF TREES, BUSHES AND LIKE IS TO BE WITH ACCORDANCE TO ODOT SECTION 201(A) AND SHOULD BE KEPT AT A MINIMUM WITHOUT SACRIFICING THE CONSTRUCTION. THE CONTRACTOR SHALL REMOVE ENOUGH VEGETATION TO BE ABLE TO MANEUVER ALL NEEDED EQUIPMENT FOR PLANNED PROJECT.

### SUPERSTRUCTURE AND SUBSTRUCTURE REPAIRS

THE EXISTING SUPERSTRUCTURE WHICH INCLUDES THE BEAMS AND DIAPHRAGMS, BUT EXCLUDING THE DECK AND THE EXISTING SUBSTRUCTURE, WHICH INCLUDES ABUTMENTS, PIERS, PIER CAPS, AND ANY OTHER CONCRETE STRUCTURE ASSOCIATED WITH THE BRIDGE, SHALL BE REPAIRED WITH "PNEUMATICALLY PLACED MORTAR".

THE ITEM "PNEUMATICALLY PLACED MORTAR" CONSTRUCTION AND MATERIALS SHALL BE IN ACCORDANCE WITH SECTION 501 OF THE STANDARD SPECIFICATIONS. ALL REMOVED MATERIAL SHALL BECOME THE PROPERTY OF THE CONTRACTOR AND DISPOSED OFF SITE IN A MANNER APPROVED BY THE ENGINEER. ANY DAMAGE DONE TO EXISTING REINFORCING STEEL BY THE CONTRACTOR'S REMOVAL OF LOOSE CONCRETE OPERATION SHALL BE REPAIRED AT THE CONTRACTOR'S EXPENSE. TO THE SATISFACTION OF THE ENGINEER. ANY DETEIORATED REINFORCING STEEL WITH SECTION LOSS GREATER THAN 50%, AS DETERMINED BY THE ENGINEER, SHALL BE REPORTED TO THE BRIDGE ENGINEER FOR REMEDIAL ACTION PRIOR TO MORTAR APPLICATION. BLAST CLEAN THE CONCRETE SURFACE AND REINFORCING STEEL FREE OF DEBRIS AND CORROSION. APPLY PNEUMATICALLY PLACED MORTAR TO REPLACE DETEIORATED CONCRETE. BUILD UP MORTAR PATCH TO MATCH EXISTING LINES AND GRADES OF SUBSTRUCTURE ELEMENTS. FAULTY REPAIRS SHALL BE REPAIRED BY THE CONTRACTOR AT NO EXPENSE TO THE CITY.

THE EXISTING SUPERSTRUCTURE TO INCLUDE THE BEAMS AND THE EXISTING SUBSTRUCTURE WHICH INCLUDES THE PIERS, PIER CAPS AND COLUMNS SHALL BE REPAIRED WITH A REER WRAP PER PLANS OR WHERE DEEMED NECESSARY BY THE ENGINEER.

THE EXISTING EXPOSED FILES SHALL BE BLASTED CLEAN OF ALL RUST AND DEBRIS AND REPAINTED TO PROTECT STRENGTH AND INTEGRITY. ALL COSTS ASSOCIATED WITH THIS WORK SHALL BE INCLUDED IN THE LUMP SUM PRICE FOR "CLEANING AND PAINTING OF EXISTING STRUCTURE". THE WORK MUST BE DONE IN ACCORDANCE TO THE ODOT SPECIFICATIONS FOR PAINTING STRUCTURES IN SECTION 512.

### BRIDGE DECK

THE EXISTING BRIDGE DECK IS TO BE REMOVED ALONG WITH THE SIDEWALK AND PARAPETS. THE REPLACEMENT BRIDGE DECK MUST BE CONSTRUCTED OF CLASS AA CONCRETE AND PER THESE PLANS AND ODOT SPECIFICATIONS. THE DEPTH IS NOT TO BE CONFORMED MORE THAN 1/2 INCH THICKNESS FROM THE DEPTH SHOWN ON THE PLANS OR THE ENGINEER MAY DEMAND REMOVAL, FORMS AND BRACING MUST BE PROVIDED TO ACCOMMODATE CONSTRUCTION LOADS AND PROPER FORM. THE BEAMS AND DIAPHRAGMS SHALL BE BRACED TO PREVENT DAMAGE AND ROTATION. ALL COSTS FOR CONCRETE, MATERIALS (EXCLUDING REINFORCING STEEL), EQUIPMENT, LABOR AND INCIDENTALS SHALL BE INCLUDED IN THE COST FOR BID ITEM "CLASS AA CONCRETE".

THE EPOXY COATED REINFORCING STEEL IS TO BE PLACED IN ACCORDANCE TO SECTION 511 "REINFORCING STEEL FOR STRUCTURES" FROM THE 2009 ODOT SPECIFICATIONS AND PER THESE PLANS. THE COST, LABOR, EQUIPMENT, AND INCIDENTALS TO THIS ITEM ARE TO BE INCLUDED IN THE COST FOR "EPOXY COATED REINFORCING STEEL". THIS BID ITEM SHALL INCLUDE ONLY THE REINFORCING STEEL INCLUDED IN THE SIDEWALK AND BRIDGE DECK.

ANY DAMAGE TO THE EXISTING STRUCTURE IS THE RESPONSIBILITY OF THE CONTRACTOR AND SHALL BE REPAIRED WITH THE APPROVAL OF THE ENGINEER. THE PLACEMENT OF THE REINFORCING STEEL AND AA CONCRETE MUST BE OVERSEEN BY THE ENGINEER TO ENSURE COMPLIANCE TO STANDARDS AND SPECIFICATIONS. ALL CONNECTED UTILITIES SHALL BE ATTACHED BACK TO BRIDGE AS THEY WERE ORIGINALLY WITHOUT DAMAGE.

FEDERAL STREET BRIDGE REHABILITATION GENERAL CONSTRUCTION NOTES			
DESIGNED BY:	DATE:	CITY OF SHAWNEE	
DRAWN BY:	DATE:	222 BRADSHAW	
CHECKED BY:	DATE:	SHAWNEE, OKLAHOMA	
APPROVED BY:	DATE:	ENGINEERING DEPARTMENT	
SCALE:	PROJECT NO.:	DATE:	

**SUMMARY OF QUANTITIES - BASE BID**

ITEM NO.	SPEC. NO.	ITEM	UNIT	QUANTITY	AS-BUILT
1	201 (A)	CLEARING AND GRUBBING	LSUM	1	
2	202 (A)	UNCLASSIFIED EXCAVATION	CY	100	
3	202 (E)	SELECT BORROW	CY	100	
4	619 (C)	REMOVAL OF EXISTING BRIDGE STRUCTURE (1)	LSUM	1	
5	412	COLD MILLING PAVEMENT	SY	60	
6	509 (A)	CLASS AA CONCRETE	(2) CY	100	
7	511 (B)	EPOXY COATED REINFORCING STEEL	LB	40,000	
8	507 (C)	ELASTOMERIC BEARING PADS	EA	24	
9	504 (E)	PARAPET	LF	220	
10	504 (A)	APPROACH SLAB	SY	110	
11	603 (E)	CONFINED CURB AND GUTTER	LF	90	
12	509	PREFORMED EXPANSION JOINT FILLER	LF	120	
13	504 (G)	RAPID CURE JOINT SEALANT	LF	100	
14	501 (C)	CLSM BACKFILL	CY	40	
15	512 (A)	CLEANING & PAINTING OF EXISTING STRUCTURE (5)	LSUM	1	
16	521 (A)	PNEUMATICALLY PLACED MORTAR	SY	30	
17	701	FIBER WRAPPING (6)	LSUM	1	
18	510 (C)	SLOPEWALL (4") (3)(4)	SY	200	
19	511 (A)	REINFORCING STEEL	LB	120	
20	221 (C)	TEMPORARY SILT FENCE	LF	150	
21	855 (A)	TRAFFIC STRIPE (PLASTIC) (4" WIDE)	LF	310	
22	880 (J)	CONSTRUCTION TRAFFIC CONTROL	LSUM	1	
23	641	MOBILIZATION	LSUM	1	
24	104	RAILROAD ACCESS EXPENSES (7)	LSUM	1	

**NOTES:**

- (1) REMOVAL OF EXISTING BRIDGE STRUCTURE ITEM IS TO INCLUDE REMOVAL AND DISPOSAL OF DECK, SIDEWALK, PARAPETS, APPROACHES, AND CURB.
- (2) CLASS AA CONCRETE IS TO INCLUDE BRIDGE DECK AND SIDEWALK.
- (3) A COMPACTED 6" BASE SHALL BE USED UNDERNEATH SLOPEWALL.
- (4) REINFORCING STEEL SHALL BE USED IN 12" INCREMENTS ALONG THE TOP OF THE SLOPEWALL PER SPECIFICATIONS IN THESE PLANS.
- (5) CLEANING AND PAINTING OF EXISTING STRUCTURES SHALL CONSIST OF SANDBLASTING ALL RUST FROM SURFACE OF PILES AND REPAIRING.
- (6) FIBER WRAPPING IS TO BE USED TO WRAP BEAMS AND COLUMN AS SPECIFIED IN PLANS AND PER DIRECTION OF THE ENGINEER.
- (7) THE BD ITEM "RAILROAD ACCESS EXPENSES" IS TO COVER ALL COSTS AND FEES ASSOCIATED WITH ACCESS INTO THE BNSF P/W WHICH MAY INCLUDE PERMITS, FEES, REVIEW OF SUBMITTALS, RR FLAGGER, AND ANY OTHER COSTS BNSF CHARGES THE CONTRACTOR/APPLICANT.

**GENERAL CONSTRUCTION NOTES**

1. ALL CONSTRUCTION AND MATERIALS, UNLESS OTHERWISE NOTED, SHALL BE IN STRICT ACCORDANCE WITH THE OKLAHOMA DEPARTMENT OF TRANSPORTATION'S STANDARD SPECIFICATIONS FOR HIGHWAY CONSTRUCTION, 2009 OR LATEST EDITION.
2. THE CONTRACTOR SHALL DELETE ALL REFERENCE TO MEASUREMENT AND PAYMENT ON STANDARD DETAIL SHEETS AND PLANS. QUANTITY TABLES ON ALL STANDARD DETAILS ARE FOR REFERENCE ONLY AND ALL QUANTITIES ARE ESTIMATED AND ARE TO BE MEASURED OUT IN THE FIELD.
3. THE CONTRACTOR SHALL CALL ONE AT 1-800-522-8543 AT LEAST 48 HOURS PRIOR TO CONSTRUCTION.
4. EXISTING UTILITY LOCATIONS AS SHOWN ON THE PLANS ARE APPROXIMATE AND SHALL BE FIELD VERIFIED BY THE CONTRACTOR FOR COPIES AND LOCATION PRIOR TO BEGINNING CONSTRUCTION. CONTRACTOR SHALL RELOCATE OR ADJUST TO GRADE UTILITIES AS SHOWN ON THE PLANS. CONTRACTOR SHALL COORDINATE CONSTRUCTION OPERATIONS WITH ALL OTHER UTILITY COMPANIES FOR THE RELOCATION OF THEIR LINES PRIOR TO BEGINNING CONSTRUCTION.
5. EVERY EFFORT HAS BEEN MADE TO LOCATE AND SIZE ALL UNDERGROUND UTILITIES FROM AVAILABLE CITY DOCUMENTS, ON SITE SURVEYS AND UTILITY COMPANY REFERENCE MATERIAL. CONTRACTOR SHALL EXERCISE EXTREME CARE AND CAUTION IN THE EXECUTION OF HIS WORK AND SHALL ANTICIPATE THAT UTILITIES, PIPELINES AND OTHER DANGEROUS UNDERGROUND OBSTRUCTIONS EXIST AND ARE NOT SHOWN ON THE PLAN AND PROFILE SHEETS. WHEN LINES OR OTHER OBSTRUCTIONS ARE LOCATED DURING CONSTRUCTION, IT IS THE CONTRACTOR'S RESPONSIBILITY TO PROTECT SUCH AND IMMEDIATELY NOTIFY THE OTHER UTILITY COMPANY AND ENGINEER.
6. TEMPORARY CONSTRUCTION RIGHTS-OF-WAY, IN ADDITION TO THOSE SHOWN ON THE PLANS, SHALL BE THE RESPONSIBILITY OF THE CONTRACTOR AND OBTAINED PRIOR TO BEGINNING ANY CONSTRUCTION OR ACTIVITY ON PRIVATE PROPERTY.
7. SURPLUS EXCAVATED MATERIALS ARE THE PROPERTY OF THE CONTRACTOR AND ARE HIS RESPONSIBILITY TO LEGALLY DISPOSE OF OFF SITE.
8. CONTRACTOR SHALL REMOVE ALL TREES AS DIRECTED BY THE CITY INSPECTOR. ALL ALL STUMPS, TREE LIMBS, BRUSH, AND OTHER DEBRIS SHALL BE HAULED OFF-SITE AND DEPOSED OF BY CONTRACTOR AT THE CONTRACTOR'S EXPENSE. A BID ITEM HAS BEEN INCLUDED FOR CLEARING AND DRIZZLING.
9. THE GENERAL CONTRACTOR IS RESPONSIBLE FOR THE PROMPT REPLACEMENT AND/OR REPAIR OF ALL TRAFFIC CONTROL DEVICES AND APPURTENANCES DAMAGED OR DISTURBED DUE TO CONSTRUCTION.
10. THE GENERAL CONTRACTOR SHALL BE RESPONSIBLE FOR INSTALLATION, REPAIR, & REPLACEMENT OF ALL EROSION CONTROL DEVICES.
11. A COPY OF THE EROSION CONTROL SITE PLAN MUST BE ON SITE AT ALL TIMES AND MADE AVAILABLE TO THE CITY INSPECTOR AT ALL TIMES.
12. THE GENERAL CONTRACTOR SHALL CONTACT THE TRAFFIC MANAGEMENT DIVISION AT LEAST TWO (2) WORKING DAYS PRIOR TO ANY WORK INVOLVING TRAFFIC. CALL (405) 873-1750.
13. THE CONTRACTOR IS RESPONSIBLE FOR THE REMOVAL OF ALL PAVEMENT MARKINGS THAT WILL BE IN CONFLICT WITH THE PROPOSED WORK.
14. THIS PROJECT IS LOCATED ABOVE BNSF RAILROAD TRACKS THUS THE CONTRACTOR MUST ADEE BY ALL BNSF RULES AND REGULATIONS FOR CONSTRUCTION WITHIN THEIR RIGHT-OF-WAY (100 FEET FROM CL ON EITHER SIDE; TOTAL 200 FEET). CONTACT KAMIE MINOR FOR MORE DETAILS AT (405)551-4434 OR COME BY THE CITY OF SHAWNEE OFFICE WHERE WE CAN SUPPLY YOU WITH THE RAILROAD TO REVIEW AND CONTRACT TO SIGN. ALL CONTRACTS MUST BE SIGNED AND SUBMITTED PLANS ACCEPTED BY BNSF BEFORE CONSTRUCTION IS TO BEGIN.

All Plans/Notes/Drawings/Specifications/Manual/Books/Forms/Drawings

FEDERAL STREET BRIDGE REHABILITATION				
PART QUANTITY SHEET				
DESIGNED BY	DATE	CITY OF SHAWNEE 222 BROADWAY SHAWNEE, OKLAHOMA		PROJECT NO.
DRAWN BY	DATE			
CHECKED BY	DATE	ENGINEERING DEPARTMENT		SHEET NO.
IN CHARGE	DATE			

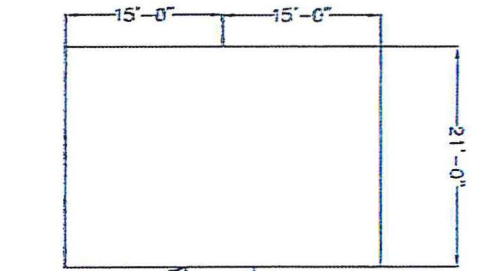
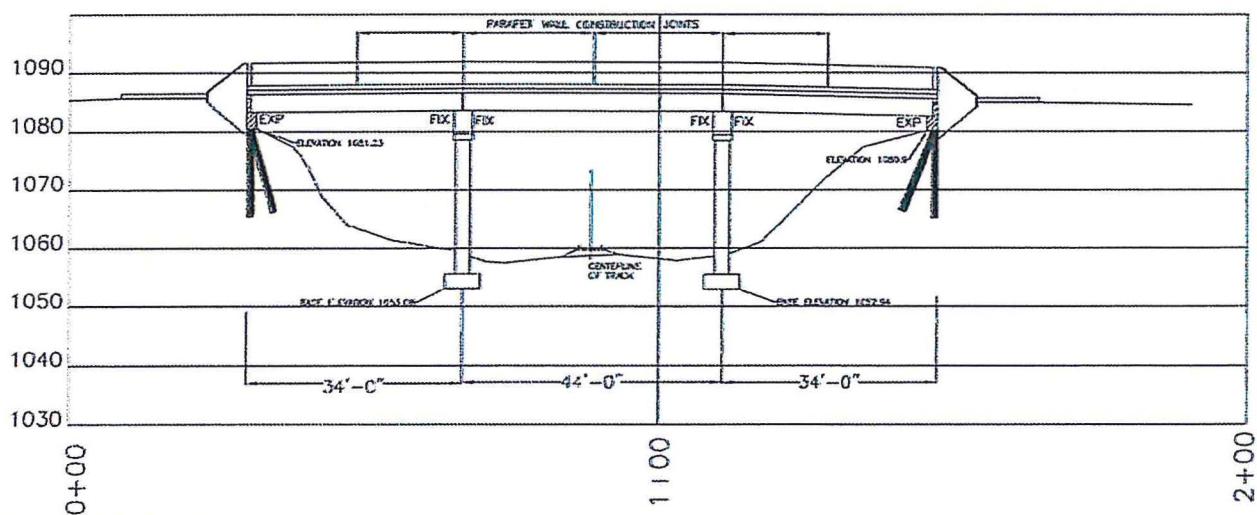
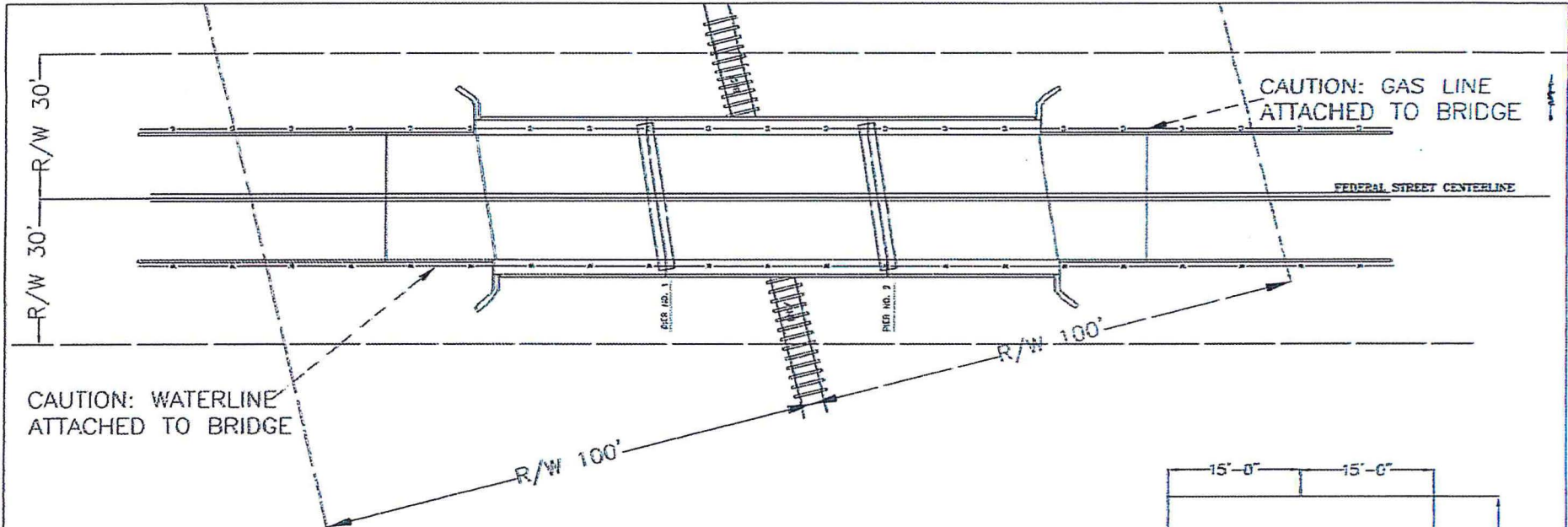

TOP RAILING OF TRACKS  
 MIN CONSTRUCTION CLEARANCE  
 DIMENSIONS MEASURED AT RIGHT ANGLES FROM TRACK. FALSEWORK CLEARANCE DURING CONSTRUCTION.

NOTE:  
 THE ELEVATION OF THE EXISTING TOP-OF-RAIL PROFILE SHALL BE VERIFIED BEFORE BEGINNING CONSTRUCTION.

FEDERAL STREET BRIDGE REHABILITATION PLAN AND PROFILE VIEWS				
DESIGNED BY	DATE	SCALE	PROJECT NO.	SHEET NO.
DRAWN BY	11/15/2008	AS SHOWN	222 BROADWAY	108
CHECKED BY			SHAWNEE, OKLAHOMA	
IN CHARGE			ENGINEERING DEPARTMENT	

A:\Projects\10808\Drawings\10808\_Plan\_Profile.dwg

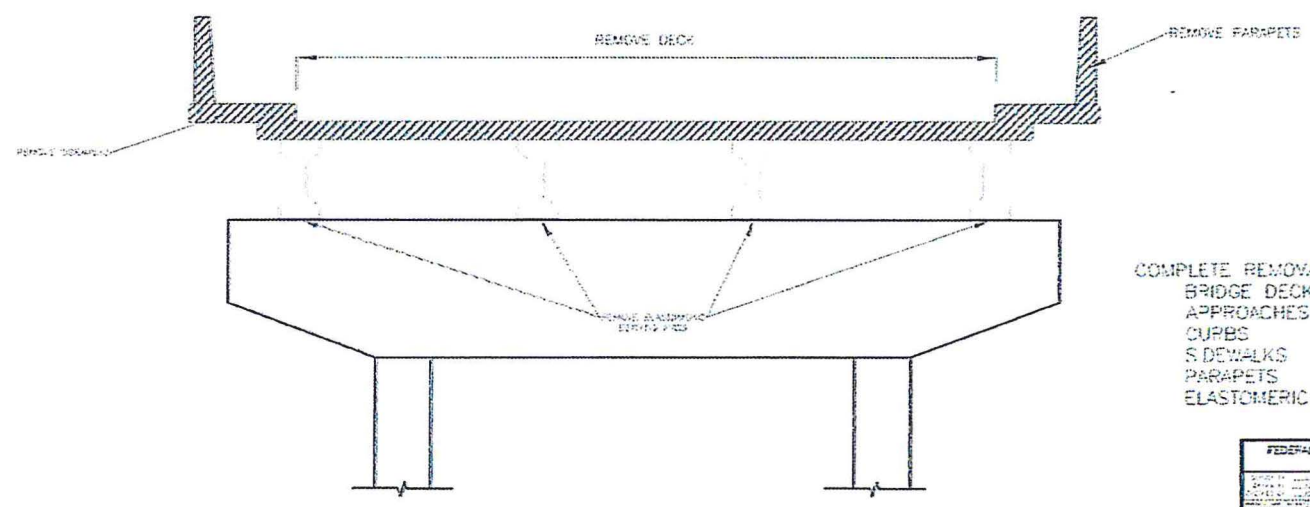
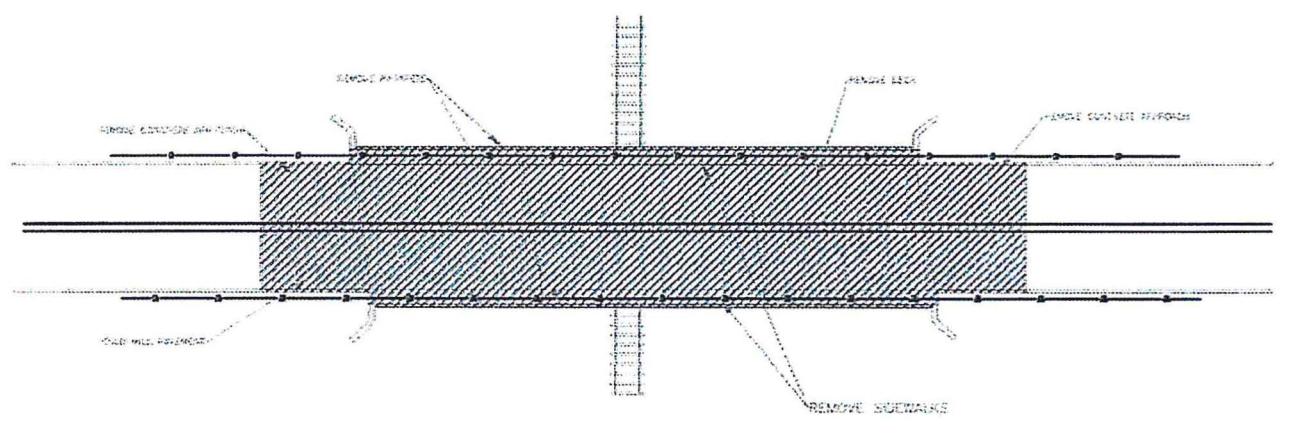

COMPLETE REMOVAL OF:  
 BRIDGE DECK  
 APPROACHES  
 CURBS  
 SIDEWALKS  
 PARAPETS  
 ELASTOMERIC BEARING PADS

FEDERAL STREET BRIDGE REHABILITATION		FISCAL YEAR	
PROJECT NO.	100-000000	START DATE	01/01/00
PROJECT NAME	FEDERAL STREET BRIDGE	END DATE	12/31/00
CITY OF CHICAGO	DEPARTMENT OF PUBLIC WORKS	ENGINEER	JOHN J. MURPHY
ENGINEERING	CHICAGO, ILLINOIS	DATE	01/01/00

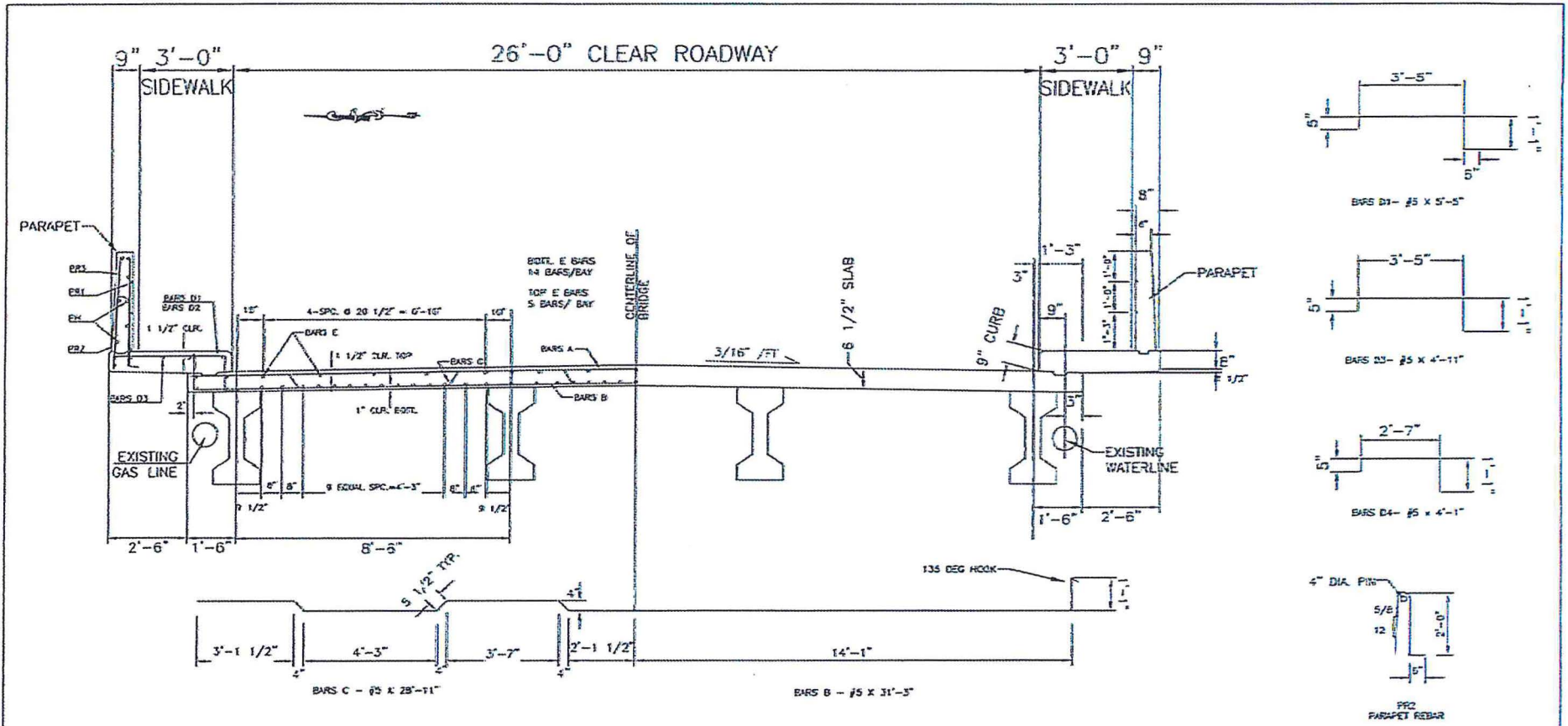

**FLOOR:** 5 1/2" SLAB, 26' CLEAR ROADWAY, CLASS AA CONCRETE, MAXIMUM AGGREGATE 1 1/2" PER CODE SPECIFICATIONS. SURFACE OF ROADWAY SLOPE 3/16" PER FOOT FROM CENTERLINE EACH DIRECTION. TOP OF CURB AND PARAPET SHALL BE BROUGHT TO A TRUE SURFACE WITH A FEGAT. ALL VERTICAL FACES OF CURB, PARAPET, AND SLAB ARE TO BE FINISHED. ALL EXPOSED EDGES SHALL HAVE 3/4" CHAMFER. ALL REINFORCEMENT IN BOTTOM OF SLAB SHALL BE SUPPORTED ON METAL SLAB SPACERS AS SHOWN. REINFORCING IN TOP OF SLAB SHALL BE SUPPORTED ON APPROVED METAL HIGH-CHAIRS AT A MAX SPACING OF 4' C. TO C.

- REIN:**
- BAR A: #5 x 28'-2" @ 12" CENTERS ACROSS ROADWAY, 1 1/2" CLEAR BELOW TOP OF SLAB
  - BAR B: #5 BENT @ 12" CENTERS ACROSS ROADWAY, 1" CLEAR ABOVE BOTTOM OF SLAB
  - BAR C: #5 BENT @ 12" CENTERS ACROSS ROADWAY, ALTERNATE BETWEEN A & B BARS
  - BAR D1: #5 BENT @ 12" CENTERS, 1 1/2" CLEAR BELOW TOP OF SIDEWALK SLAB
  - BAR D2: #4 x 3'-5" @ 12" CENTERS, 1 1/2" CLEAR BELOW TOP OF SIDEWALK SLAB, ALTERNATE BETWEEN D1 BARS
  - BAR D3: #4 - 6 PLACED AS SHOWN IN EACH SIDEWALK SLAB
  - BAR E: #4 - 65 TOTAL IN ROADWAY SLAB PLACED AS SHOWN
  - BAR FR1: #4 BENT @ 12" CENTERS IN PARAPET WALL
  - BAR FR2: #4 BENT @ 12" CENTERS IN PARAPET WALL, ALTERNATE BETWEEN FR1 BARS
  - BAR PH: #3 x 3'-4" @ 12" CENTERS IN PARAPET WALL, ALTERNATE BETWEEN FR1 BARS
  - BAR PH: #4 - 7 PLACED IN EACH PARAPET WALL AS SHOWN.

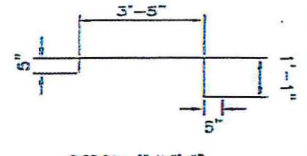

BAR D1 - #5 x 3'-5"

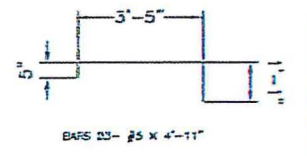

BAR D3 - #5 x 3'-5"

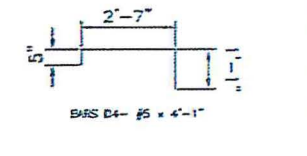

BAR D4 - #5 x 2'-7"

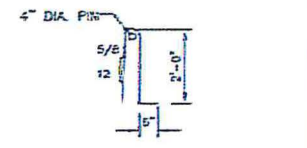

FR2 PARAPET REBAR

FEDERAL STREET BRIDGE REHABILITATION BRIDGE DECK DETAILS				
DESIGNED BY:	DATE:	CITY OF SHAWNEE	PROJECT NO.	SHEET NO.
DRAWN BY:	DATE:	222 BROADWAY		
CHECKED BY:	DATE:	SHAWNEE, OKLAHOMA		
APPROVED BY:	DATE:	ENGINEERING DEPARTMENT		
DATE:	SCALE:	PROJECT NO.:		SHEET NO.:

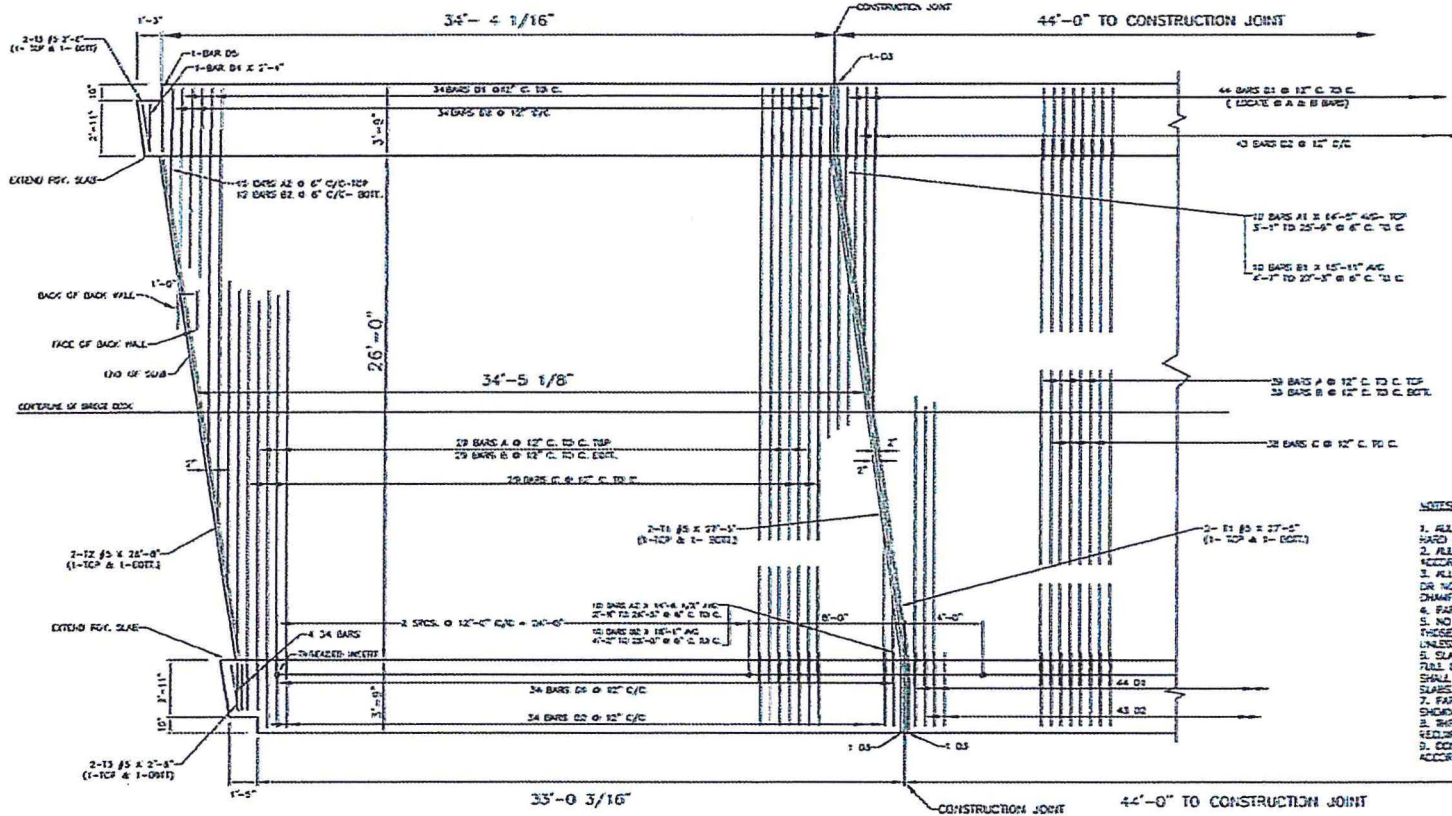

- NOTES ON DECK SLAB
1. ALL REINFORCING SHALL BE INTERMEDIATE OR HARD GRADE STEEL.
  2. ALL CONSTRUCTION AND MATERIAL SHALL BE IN ACCORDANCE WITH CURRENT DOT STANDARDS.
  3. ALL EXPOSED EDGES UNLESS OTHERWISE SHOWN OR NOTED SHALL HAVE 3/4\"
  4. PARAPET WALL SHALL BE CHAMFERED 1/2\"
  5. NO SPlicing OF REINFORCING BARS, EXCEPT THOSE SHOWN ON THE PLANS, WILL BE PERMITTED UNLESS SPECIFICALLY APPROVED BY THE ENGINEER.
  6. SLAB FIELDS SHALL BE CONTINUOUS FOR THE FULL LENGTH OF EACH SPAN. SIDEWAY SLABS SHALL BE FURRED SEPARATELY FROM THE ROADWAY SLABS.
  7. PARAPET WALL SHALL HAVE CONSTRUCTION JOINTS SHOWN ON THE DETAIL.
  8. THREADED INSERTS SOUTH SIDE ONLY, 10 TOTAL REQUIRED.
  9. CONSTRUCTION JOINTS SHALL BE SAFTD ACCORDING TO DOT SPECIFICATIONS.

PART PLAN - DECK SLAB REINFORCING

FEDERAL STREET BRIDGE REHABILITATION			
BRIDGE DECK DETAILS			
DESIGNED BY	DATE	CITY OF SHAWNEE	
CHECKED BY	DATE	222 BROADWAY	
PROJECT NO.		SHAWNEE, OKLA-75084	
ENGINEER	SCALE	ENGINEERING DEPARTMENT	

11/19/2013 10:08 AM C:\Users\jgarcia\AppData\Local\Temp\AutoCAD\2013\11\19\20131119100800.dwg

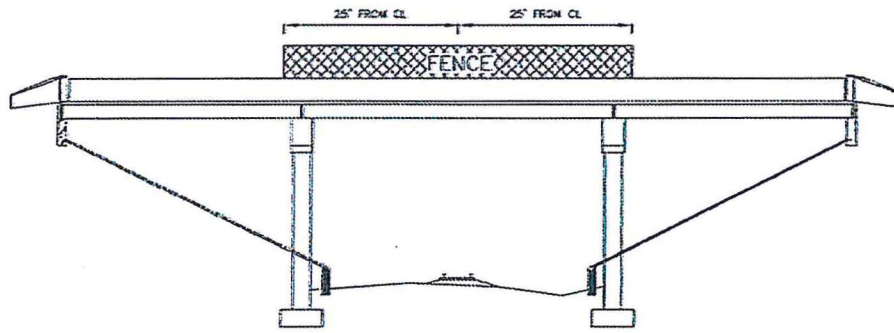

PROFILE OF BRIDGE FENCE

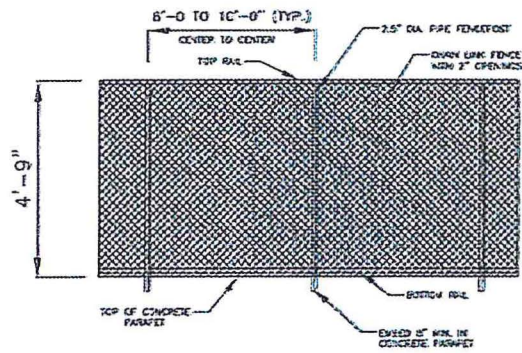
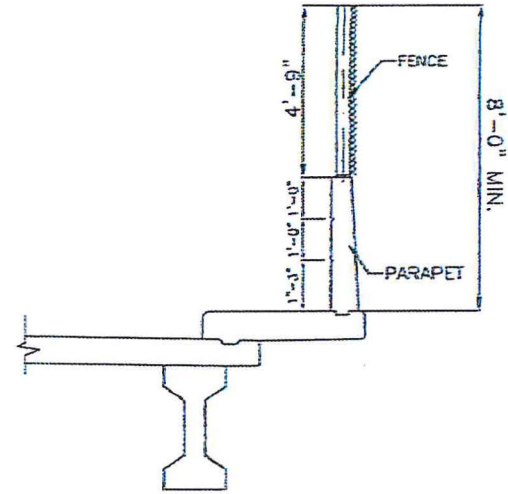

CHAIN LINK FENCE

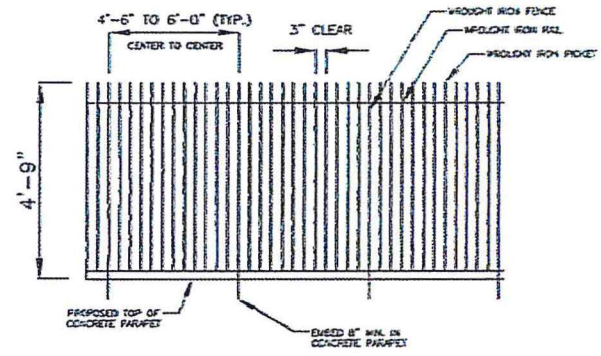

WROUGHT IRON PICKET FENCE

FEDERAL STREET BRIDGE REHABILITATION FENCE DETAILS				
DESIGNED BY	DATE	SCALE	PROJECT NO.	SHEET NO.
CHECKED BY	2011/12	AS SHOWN	100-100-100	24
CITY OF SHAWNEE 222 BRIDGWAY SHAWNEE, OKLAHOMA		 ENGINEERING DEPARTMENT		

All Dimensions Unless Otherwise Specified. Refer to Typical Mechanical Details for Details. 2011/12

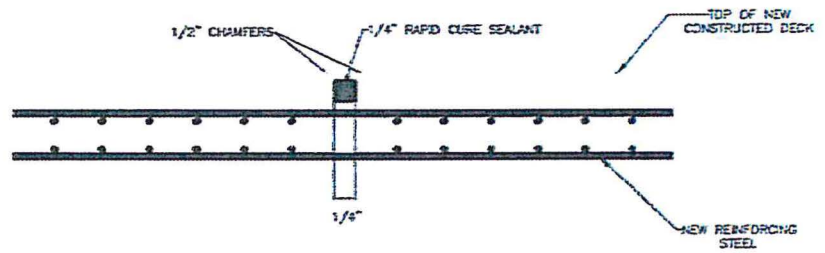
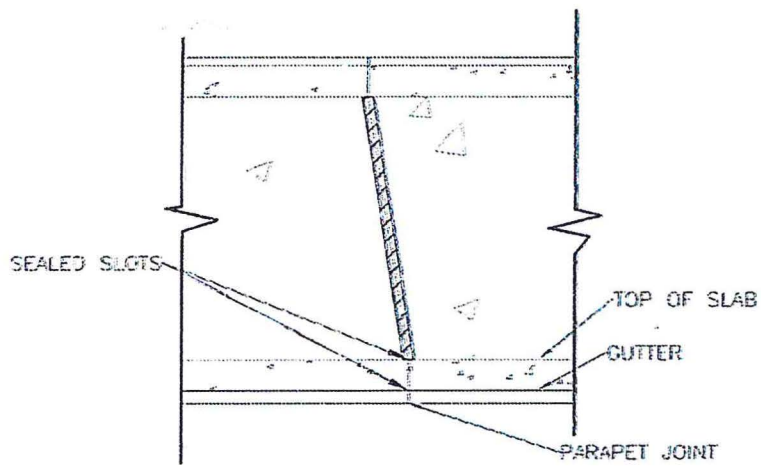
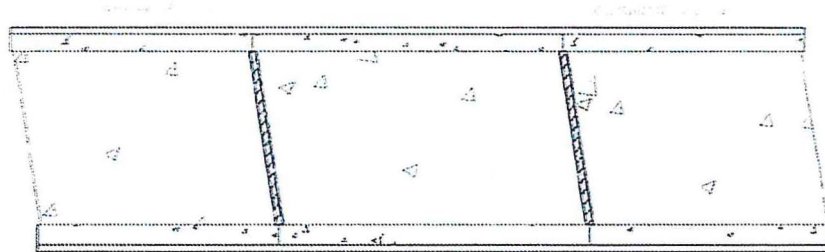

CONSTRUCTION JOINT DETAILS

JOINT SPACING

PARAPET WALL JOINTS AS SHOWN SHALL BE LOCATED AT CONSTRUCTION JOINTS IN SLAB AND AT APPROXIMATE MID-POINTS OF EACH SPAN.

FEDERAL STREET BRIDGE REHABILITATION		
CONSTRUCTION JOINT DETAILS		
DRAWN BY: [ ] CHECKED BY: [ ] DESIGNED BY: [ ] APPROVED BY: [ ] DATE: [ ]	CITY OF CHAMPEE 222 BROADWAY CHAMPEE, CALIFORNIA	
ENGINEERING DEPARTMENT		



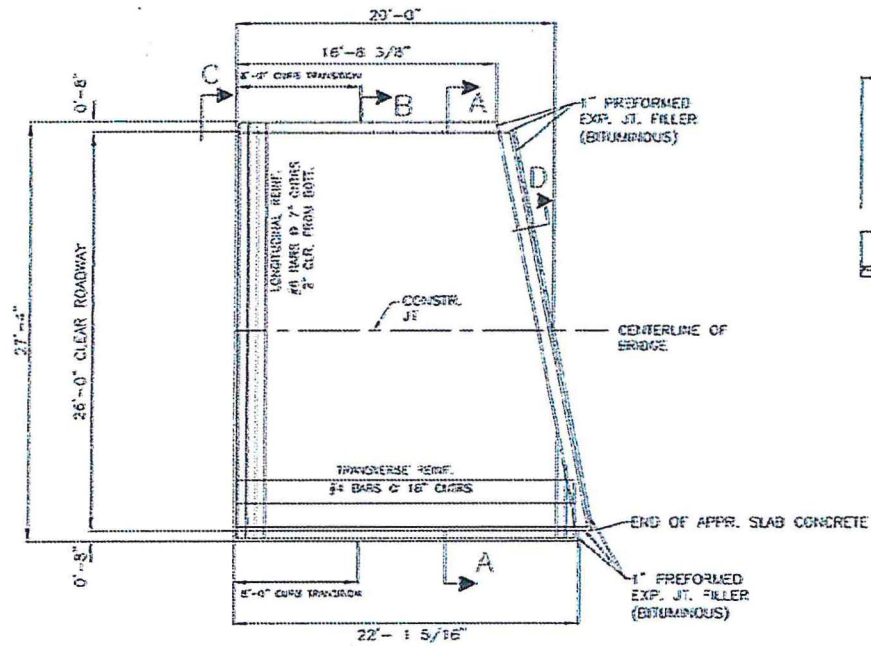

TYPICAL PLAN - APPROACH SLAB

NOTE: FOUR (4) INCH CLEM. CUSHION SHALL BE PLACED AND COMPACTED UNDER ENTIRE AREA OF APPROACH SLAB.

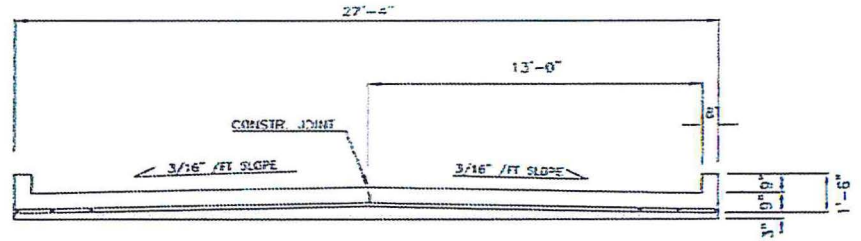

SECTION A-A

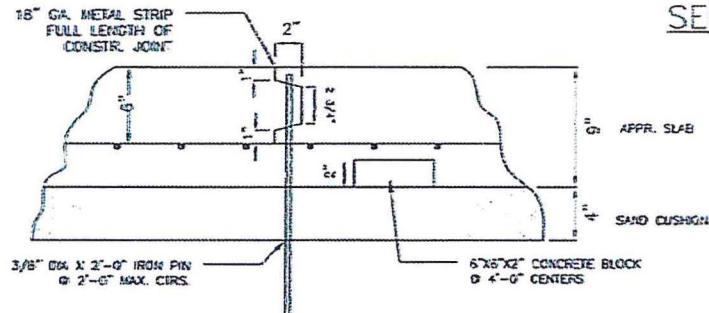
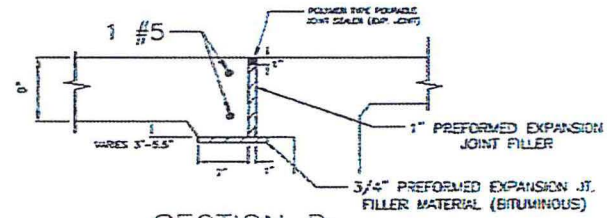
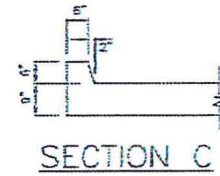
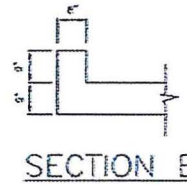

DETAIL OF CONSTRUCTION JOINT AND BAR SUPPORT

FEDERAL STREET BRIDGE REHABILITATION				
APPROACH DETAILS				
DESIGNED BY:	DATE:	CITY OF SHAWNEE		SHEET NO.
DRAWN BY:	DATE:	222 BROADWAY		
CHECKED BY:	DATE:	SHAWNEE, OKLAHOMA		
SCALE:	PROJECT NO.:	ENGINEERING DEPARTMENT		
DATE:	SCALE:	PROJECT NO.:		

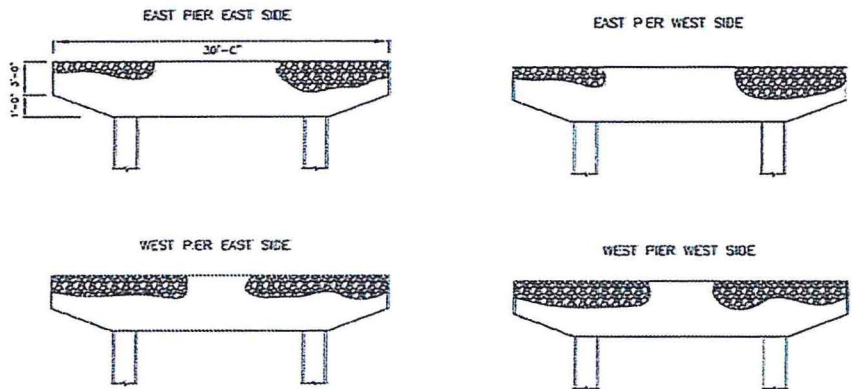

PIER VIEWS

NOTES:  
 PNEUMATICALLY PLACED MORTAR IS TO BE PLACED ON PIERS AND COLUMNS AS NEEDED AND DIRECTED BY THE ENGINEER PER CDOT 2009 SPECS.  
 FIBER WRAPPING WILL BE PERFORMED FROM THE DIRECTION OF THE ENGINEER ON BEAMS, COLUMNS, AND PIERS.

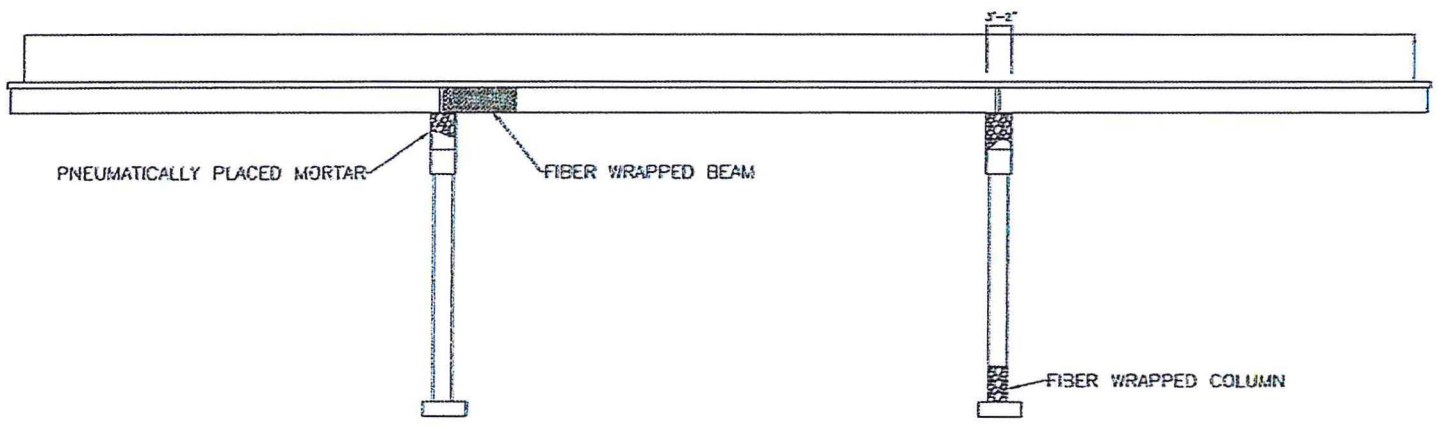

BEAM & COLUMN VIEWS LOOKING SOUTH  
 PNEUMATICALL PLACED MORTAR & FIBER WRAPPING

FEDERAL STREET BRIDGE REHABILITATION PIERS AND BEAMS REPAIR				
DESIGNED BY:	DATE:	CITY OF SHARNEE		
DRAWN BY:	DATE:	222 BROADWAY		
CHECKED BY:	DATE:	SHARNEE, OKLAHOMA		
ENGINEERING DEPARTMENT				
DIVISION:	ENGINEER:	SCALE:	PROJECT NO.:	DRAWING NO.:

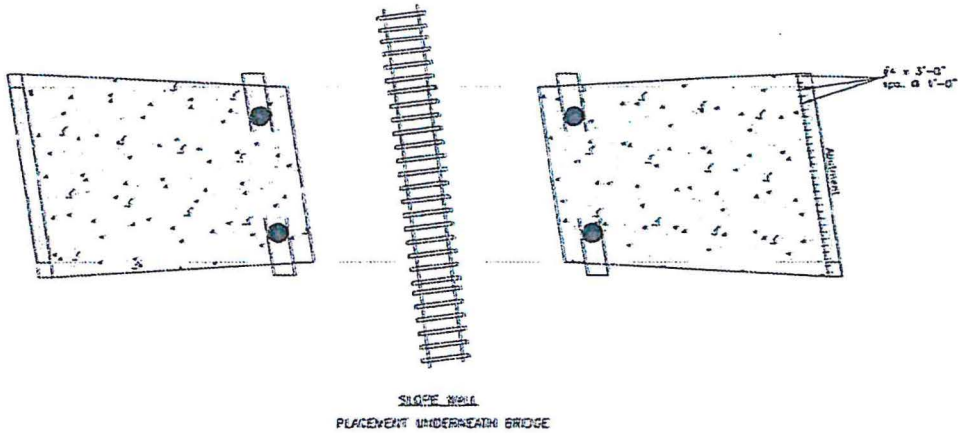

NOTES:

PERMANENT HORIZONTAL CLEARANCE SHALL BE 16 FEET MEASURED PERPENDICULAR FROM THE CENTERLINE OF TRACK TO THE FACE OF THE FIER PROTECTION (SLOPEWALL).

FOOTINGS SHALL BE LOCATED TO ALLOW A MINIMUM OF 12 FEET TEMPORARY HORIZONTAL CONSTRUCTION CLEARANCE MEASURED AT A RIGHT ANGLE FROM THE CENTERLINE OF TRACK.

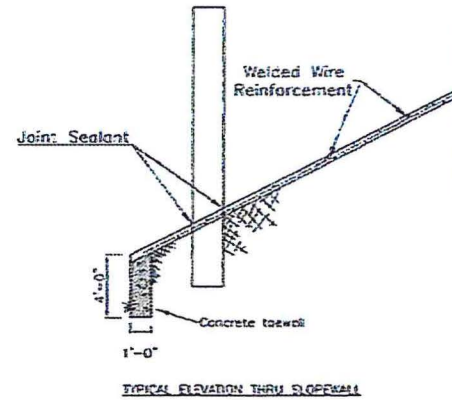
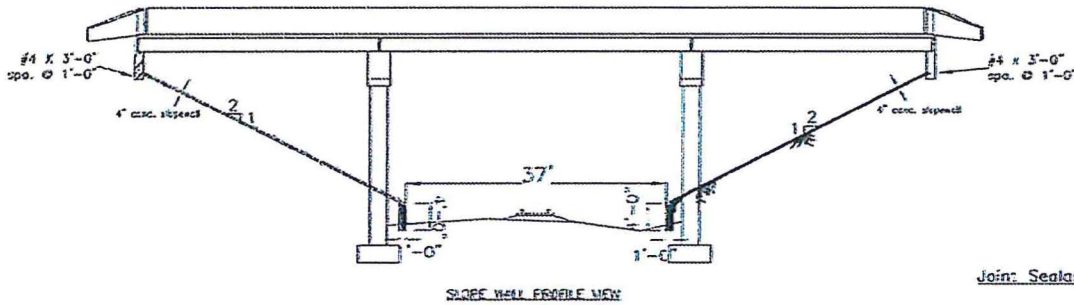
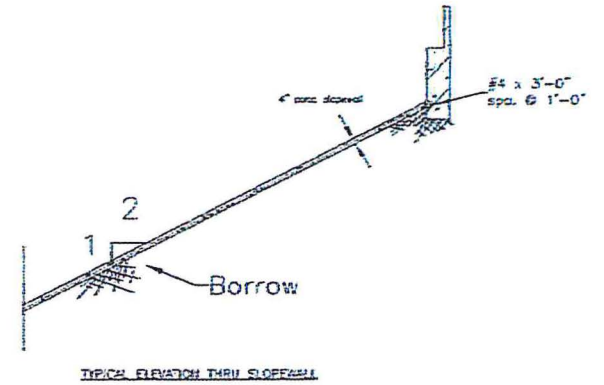

FEDERAL STREET BRIDGE REHABILITATION					
SLOPEWALL DETAILS					
DESIGNED BY:	DATE:	CITY OF SHAWNEE	PROJECT NO.	SHEET NO.	
CHECKED BY:	DATE:	222 BROADWAY			
		SHAWNEE, OKLAHOMA			
		ENGINEERING DEPARTMENT			
DRAWN BY:	SCALE:				

All dimensions in parentheses are approximate dimensions for reference only.

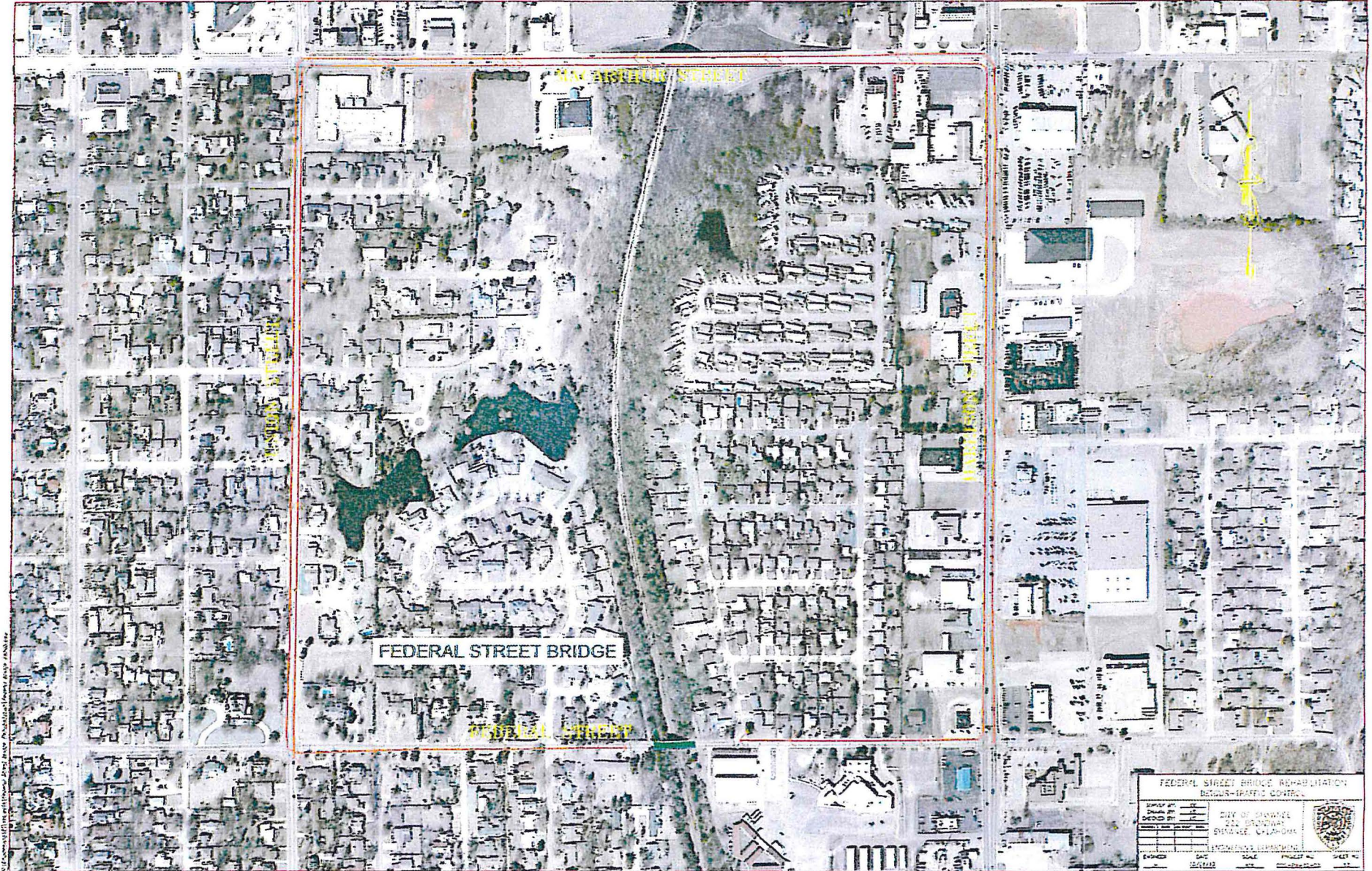

FEDERAL STREET BRIDGE

FEDERAL STREET

FEDERAL STREET

FEDERAL STREET BRIDGE RENOVATION  
BEGIN-TRAFFIC CONTROL

DATE	SCALE	PROJECT NO.	SHEET NO.
2014	AS SHOWN	100000000	100

CITY OF CHICAGO  
222 BROADWAY  
CHICAGO, ILLINOIS 60604



ENGINEER'S EXAMINATION

Copyright © 2014 by Esri. All rights reserved. ArcGIS, ArcView, and ArcMap are registered trademarks of Esri. All other marks are the property of their respective owners.



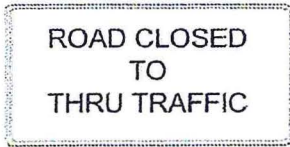

R11-4 ROAD CLOSED SIG.



R11 BRIDGE OUT SIG.



DETOUR 114-100



DETOUR 114-101

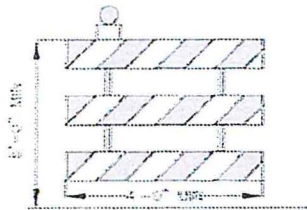

TYPE 2 BARRICADE

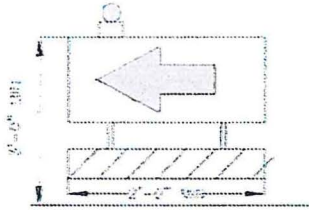

DIRECTION INDICATOR BARRICADE



R5-4 BE PREPARED TO STOP SIG.



W01-6 BRIDGE REPAIR SIG.

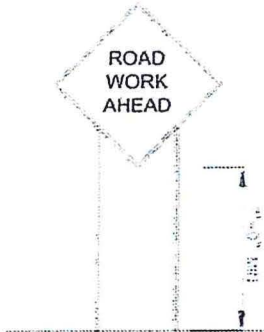

URBAN DISTRICT (ROAD WORK AHEAD)

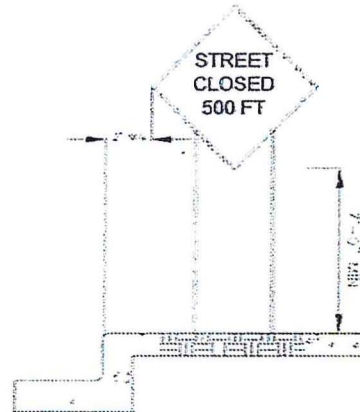

URBAN DISTRICT (WITH CURB)

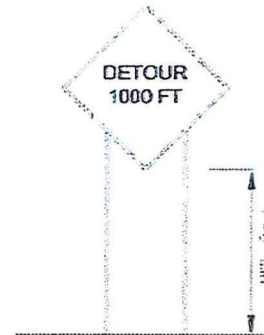

URBAN DISTRICT (DETOUR)

NOTES:

WORD SIGNS MAY BE USED IF SYMBOL SIGNS ARE NOT AVAILABLE EITHER IN "STANDARD HIGHWAY SIGN MANUAL" OR IN THE MANUAL (CURRENT EDITION).

ALL DIAMOND SHAPE CONSTRUCTION WARNING SIGNS SHALL BE 30 INCHES BY 30 INCHES UNLESS OTHERWISE NOTED IN THE MANUAL.

FEDERAL STREET BRIDGE REHABILITATION TRAFFIC CONTROL STANDARDS

APPROVED BY:	CITY OF SHAWNEE	
DATE:	200 BROADWAY	
DESIGNED BY:	SHAWNEE DEVELOPMENT	
DATE:		

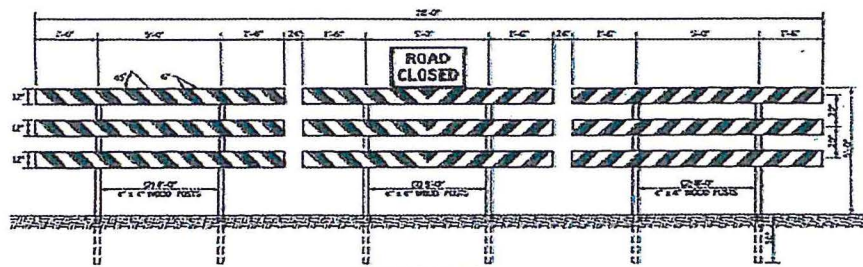

WHEN ROAD ENDS

PERMANENT TYPE III(A/B) BARRICADE  
DIMENSIONS ARE TYPICAL FOR 80% OBSTRUCTION

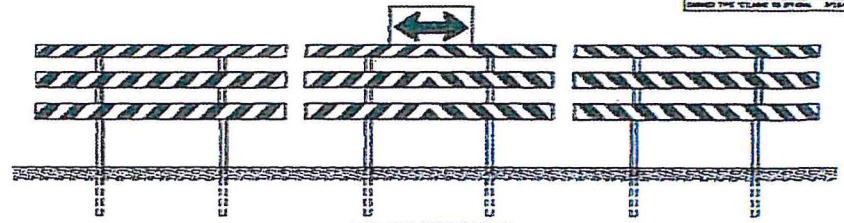

FOR T-INTERSECTIONS

NOTE: A PORTABLE BARRICADE TYPE III SHALL CONSIST OF ONE OR MORE OF THE FOLLOWING:  
TYPICAL INSTALLATION AS SHOWN IS FOR AN ABSOLUTE OBSTRUCTION.  
BARRICADES SHOULD NOT BE PLACED PARALLEL TO TRAFFIC IF THIS OBSCURES CLEAR ZONE.

PORTABLE BARRICADE TYPE III SHALL BE CONSTRUCTED TO TYPE III WITH ONE OR MORE ADDITIONAL PORTABLE BARRICADE PANELS ATTACHED TO THE BACK SIDE OF THE BARRICADE.  
COLOR: BARRICADE - WHITE PORTABLE STRIPES - RED PORTABLE STRIPES - RED PORTABLE STRIPES

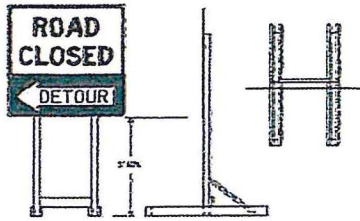

Skid-mounted Sign Support with plywood sign

LONG/INTERMEDIATE TERM STATIONARY PORTABLE SIGN SUPPORTS  
5 Foot Mounting Height  
15-0" MOUNTING  
SHALL BE PLACED BEHIND TYPE III BARRICADE

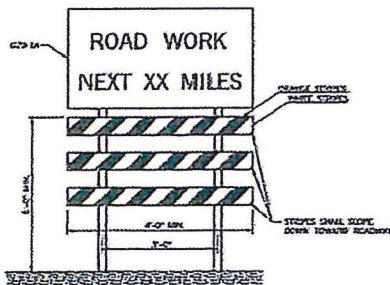

WING BARRICADE

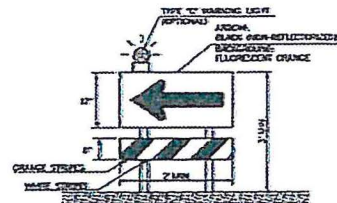

DIRECTION INDICATOR BARRICADE

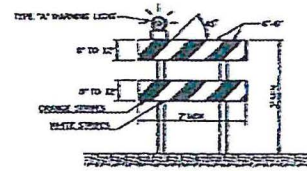

TYPE II BARRICADE

NOTES: FOR WOODEN BARRICADES MINIMUM MEMBER DIMENSIONS WILL BE SATISFACTORY FOR DIMS LESS THAN 3 FEET LONG. A MINIMUM STRIPES SHALL BE USED. TYPE III BARRICADES SHALL BE CONSTRUCTED USING A MINIMUM OF TWO 4x4 POSTS. FOR WOODEN BARRICADES, PANEL DIMENSIONS SHALL NOT EXCEED ONE-HALF HIGH CLEAR.

BARRICADES SHOULD NOT BE PLACED PARALLEL TO TRAFFIC IF NOT OBSCURE CLEAR ZONE. PARALLEL WITH TRAFFIC SHOULD BE USED ONLY ON SIDE OF A 2-LANE ROADWAY AND BOTH SIDES OF A DIVIDED HIGHWAY.

ALL BARRICADE STRIPES SHALL BE REFLECTIVE. COLOR: BARRICADE - WHITE PORTABLE STRIPES - RED PORTABLE STRIPES - RED PORTABLE STRIPES

IF BARRICADES ARE USED TO OBSTRUCT TRAFFIC, THERE SHALL BE COMPLETELY OBSTRUCTED SECTION AND TOP RAILS WITH NO GAPS BETWEEN INDIVIDUAL BARRICADES TO BE PERMISSIBLE TO LANDING OF SOME ITEMS. THE BOTTOM OF THE BOTTOM RAIL SHALL BE NO HIGHER THAN 6 INCHES ABOVE THE BARRICADE SURFACE. THE TOP OF THE TOP RAIL SHALL BE NO LOWER THAN 24 INCHES ABOVE THE BARRICADE SURFACE.

STRIPES MOUNTED ON TYPE III BARRICADES SHOULD NOT COVER MORE THAN 10 PERCENT OF THE TOP TWO RAILS OR 25 PERCENT OF THE TOTAL AREA OF THE THREE RAILS. STRIPES MOUNTED ON BARRICADES OR OTHER PORTABLE SUPPORTS SHALL BE NO LESS THAN 1/2 INCHES ABOVE THE BARRICADE SURFACE.

BARRICADES MAY BE PLACED ON LOWER PARTS OF THE FRAME OF THE STRIPS OF BARRICADES TO PRODUCE THE DESIRED BALLAST.

BARRICADES SHALL NOT BE PLACED ON TOP OF ANY STRIPES RAIL. BARRICADES SHALL NOT BE BARRICADED BY NONPERMISSIBLE OBJECTS SUCH AS ROCKS OR CHAINS OF CONCRETE. BARRICADES SHALL NOT BE USED AND THE ACCEPTABLE PRACTICE WITHIN OF.

DIRECTION INDICATOR BARRICADES SHALL CONSIST OF A ONE-DIRECTION LARGE ARROW 10x15 SIGN MOUNTED ABOVE A DIRECTION STRIPES BARRICADE. BARRICADES SHALL BE CONSTRUCTED TO TYPE III WITH ONE OR MORE ADDITIONAL PORTABLE BARRICADE PANELS ATTACHED TO THE BACK SIDE OF THE BARRICADE.

WHERE BARRICADES EXTEND DIRECTLY AHEAD OF TRAFFIC, THE STRIPES SHOULD SLOPE DOWNWARD IN THE DIRECTION TOWARD WHICH ROAD USERS MUST TURN. WHERE BOTH RIGHT AND LEFT TURNS ARE PROVIDED, THE BARRICADE STRIPES SHOULD SLOPE DOWNWARD IN BOTH DIRECTIONS FROM THE CENTER OF THE BARRICADE OR BARRICADES.

WHERE NO TURNS ARE PROVIDED, THE STRIPES SHOULD BE POSITIONED TO SLOPE DOWNWARD TOWARD THE CENTER OF THE BARRICADE OR BARRICADES.

BASIS OF PAYMENT		
ITEM NO.	ITEM	UNIT
2802B	CONSTRUCTION SIGN	SD
2802C	CONSTRUCTION BARRICADES	SD
2802D	TRAVELING LIGHTS	SD



APPROVED BY: *[Signature]* DATE: 2/2/12  
TRAFFIC ENGINEER

TRAFFIC STANDARD  
TRAFFIC CONTROL STANDARD  
TRAFFIC CONTROL DEVICES

SHEET 16  
TCS4-1 01

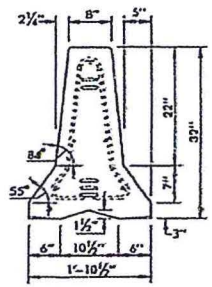

END VIEW

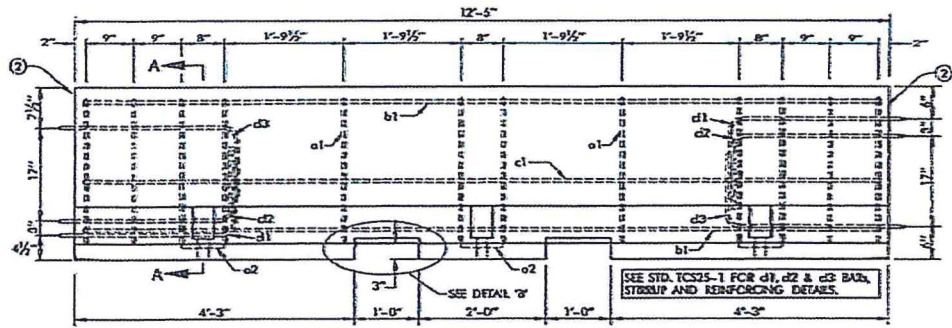

ELEVATION VIEW

SEE STD. TCS25-1 FOR d1, d2 & d3 BARS, STIRRUP AND REINFORCING DETAILS.

- DRAWING NOTES:**
- 1 INCH RADIUS ALLOWED FOR EASE OF CASTING.
  - THE TOP SURFACE OF ONE END OF EACH BARRIER UNIT SHALL BE PERMANENTLY MARKED INDICATING THE FOLLOWING INFORMATION:
    - NCHRP REPORT 350 APPROVED
    - TYPE F BARRIER
    - MANUFACTURER IDENTIFICATION
    - DATE MANUFACTURED (MONTH AND YEAR)
 EXAMPLE: 350F-SM9(0) (SIA-SMITH MATERIALS)
  - 1 INCH CHAMFER TO PREVENT SPALLING

**GENERAL NOTES:**

- ALL CONSTRUCTION AND MATERIAL REQUIREMENTS OF THE PORTABLE PRECAST CONCRETE MEDIAN BARRIER PROVIDED BY THE CONTRACTOR SHALL BE IN ACCORDANCE WITH THE 2009 ENGLISH STANDARD SPECIFICATIONS & MEET REQUIREMENTS OF NCHRP REPORT 350, TEST LEVEL 3. CONTRACTOR MAY PROVIDE ANY PORTABLE F-SHAPE BARRIER DESIGN MEETING THE REQUIREMENTS OF NCHRP REPORT 350, SO LONG AS THE MATERIAL REQUIREMENTS OF 2009 STANDARD SPECIFICATIONS ARE MET.
- CONCRETE FOR PORTABLE PRECAST CONCRETE MEDIAN BARRIER SHALL REACH A MINIMUM OF 4000 PSI STRENGTH AFTER 28 DAYS.
- ALL REINFORCEMENT SHALL BE DEFORMED GRADE 60, A6030 AT 31, EXCEPT FOR THE CONNECTION LOOP BAR ASSEMBLY SHALL BE SMOOTH #6 BARS WITH A MINIMUM YIELD STRENGTH OF 60 KSI, A MINIMUM TENSILE STRENGTH OF 80 KSI, AND PASSING A 180 DEGREE BEND TEST USING A 2 1/2" PIN BEND DIAMETER. THE LOOPS SHALL BE INSTALLED WITHIN 1/2" OF THE PLAIN DIMENSION.
- CONTRACTOR SHALL FINISH AND INSTALL REFLECTIVE MARKERS ON BARRIER AS RECOMMENDED BY THE MANUFACTURER AND SHOWN ON THIS SHEET. THE MARKERS SHALL BE INSTALLED AT NOMINAL 12.5 FOOT SPACING AND FACE ONCOMING TRAFFIC. THE CONTRACTOR SHALL MAINTAIN THE MARKERS AND PROMPTLY REPLACE OR REPLACE ANY DAMAGED OR MISSING UNITS. ALL COSTS FOR FINISHING, INSTALLING AND MAINTAINING MARKERS SHALL BE INCLUDED IN THE PRICE BID FOR THE TEMPORARY BARRIER RAIL.
- UNLESS STATED OTHERWISE IN THE PLANS, THE BARRIER RAIL SECTIONS SHALL REMAIN THE PROPERTY OF THE CONTRACTOR AND AT THE COMPLETION OF THE WORK SHALL BE REMOVED FROM THE SITE BY CONTRACTOR.
- WHEN TEMPORARY BARRIER RAIL IS INSTALLED WITHIN 2 FEET OF A DROP-OFF, BARRIER SECTIONS SHALL BE ANCHORED WITH THE DOWN PINS AS DESCRIBED AND SHOWN ON TIE-DOWN DETAIL THIS SHEET. SEE ROADWAY STD. PDT-2 (LATEST REVISION) FOR PAVEMENT EDGE DROP-OFF DETAILS.

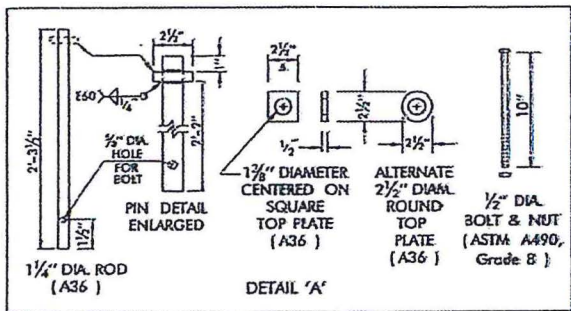

DETAIL 'A'

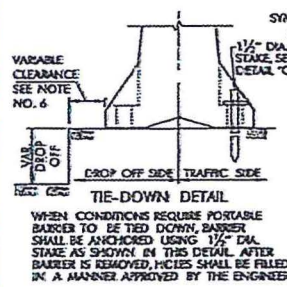

WHEN CONDITIONS REQUIRE PORTABLE BARRIER TO BE TIED DOWN, BARRIER SHALL BE ANCHORED USING 1 1/2" DIA. STAKE AS SHOWN IN THIS DETAIL. AFTER BARRIER IS REMOVED, HOLES SHALL BE FILLED IN A MANNER APPROVED BY THE ENGINEER.

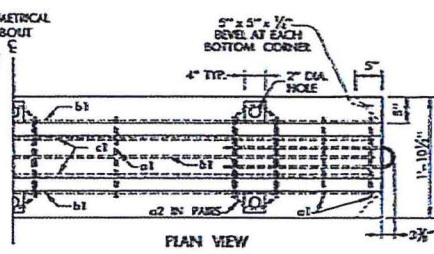

PLAN VIEW

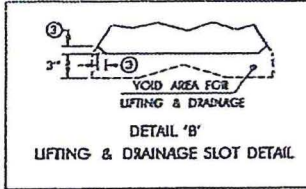

DETAIL 'B'  
LIFTING & DRAINAGE SLOT DETAIL

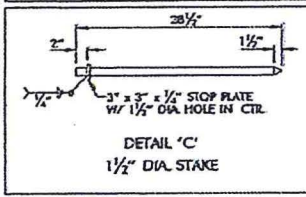

DETAIL 'C'  
1 1/2" DIA. STAKE

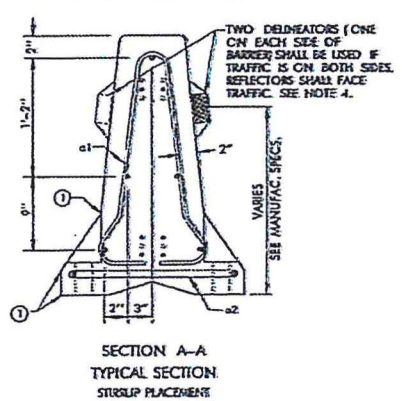

SECTION A-A  
TYPICAL SECTION  
STIRRUP PLACEMENT

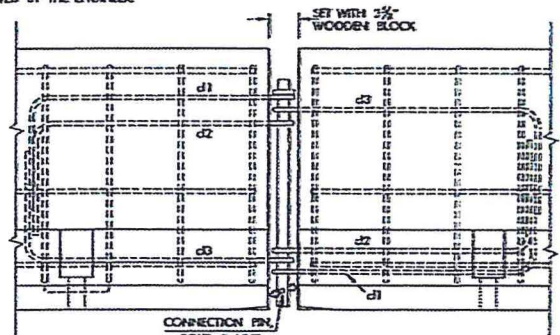

DETAILS OF BARRIER SECTION CONNECTION

BASIS OF PAYMENT		
ITEM NO.	ITEM	UNIT
0720A	PORTABLE LONGITUDINAL BARRIER	L.F.
0720B	DESIGN PORTABLE LONGITUDINAL BARRIER	L.F.
0770	REMOVAL OF PORTABLE LONGITUDINAL BARRIER	L.F.

THIS STANDARD SHALL BE USED IN CONSTRUCTION WITH TCS25-1.

APPROVED BY: *[Signature]* DATE: 05/2014

TRAFFIC STANDARD

TRAFFIC CONTROL STANDARD  
PORTABLE LONGITUDINAL BARRIER

SHEET 17

2009 SPECIFICATIONS (NCHRP 350 F-SHAPE) TCS24-1 01 T-524



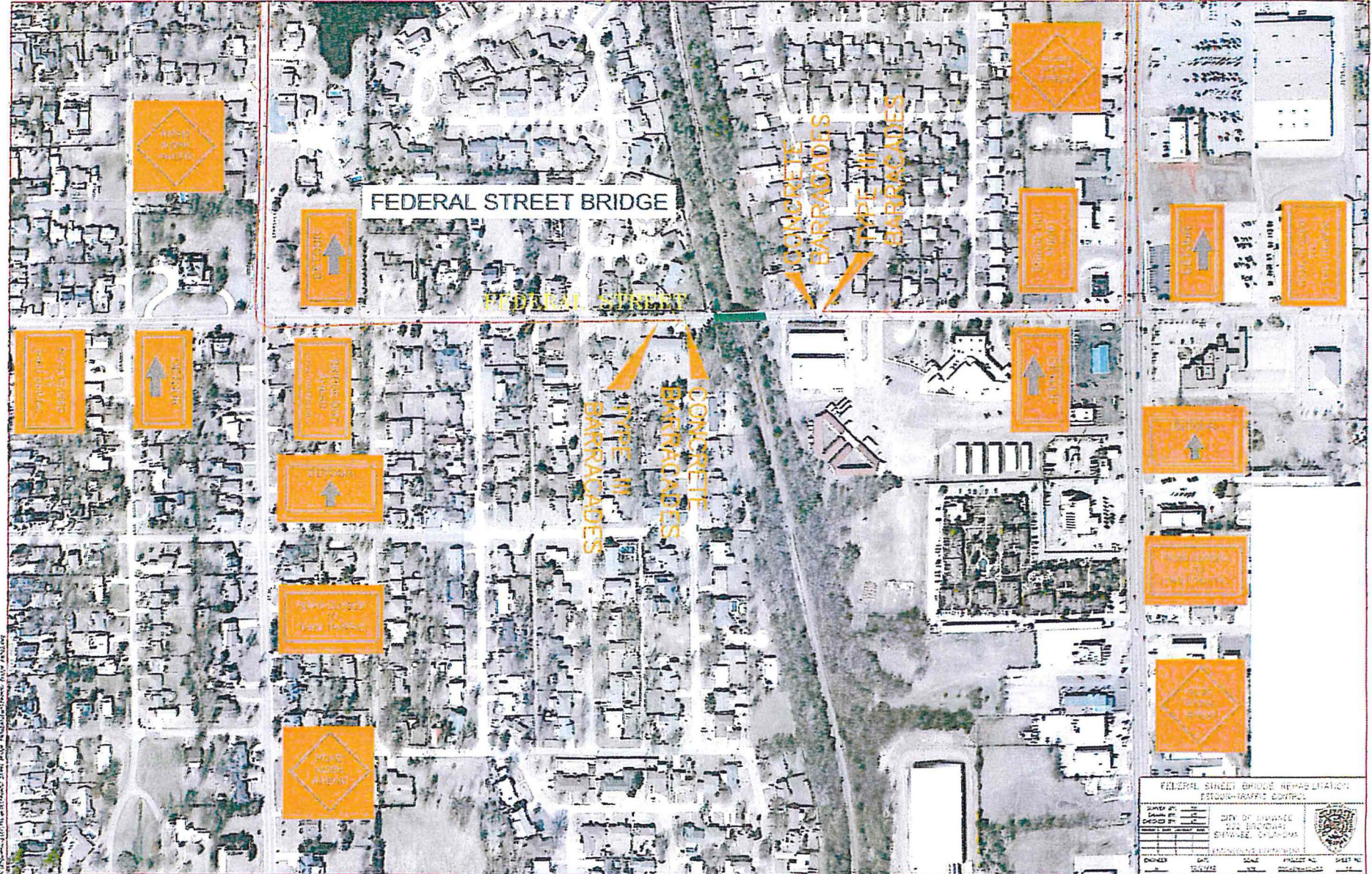

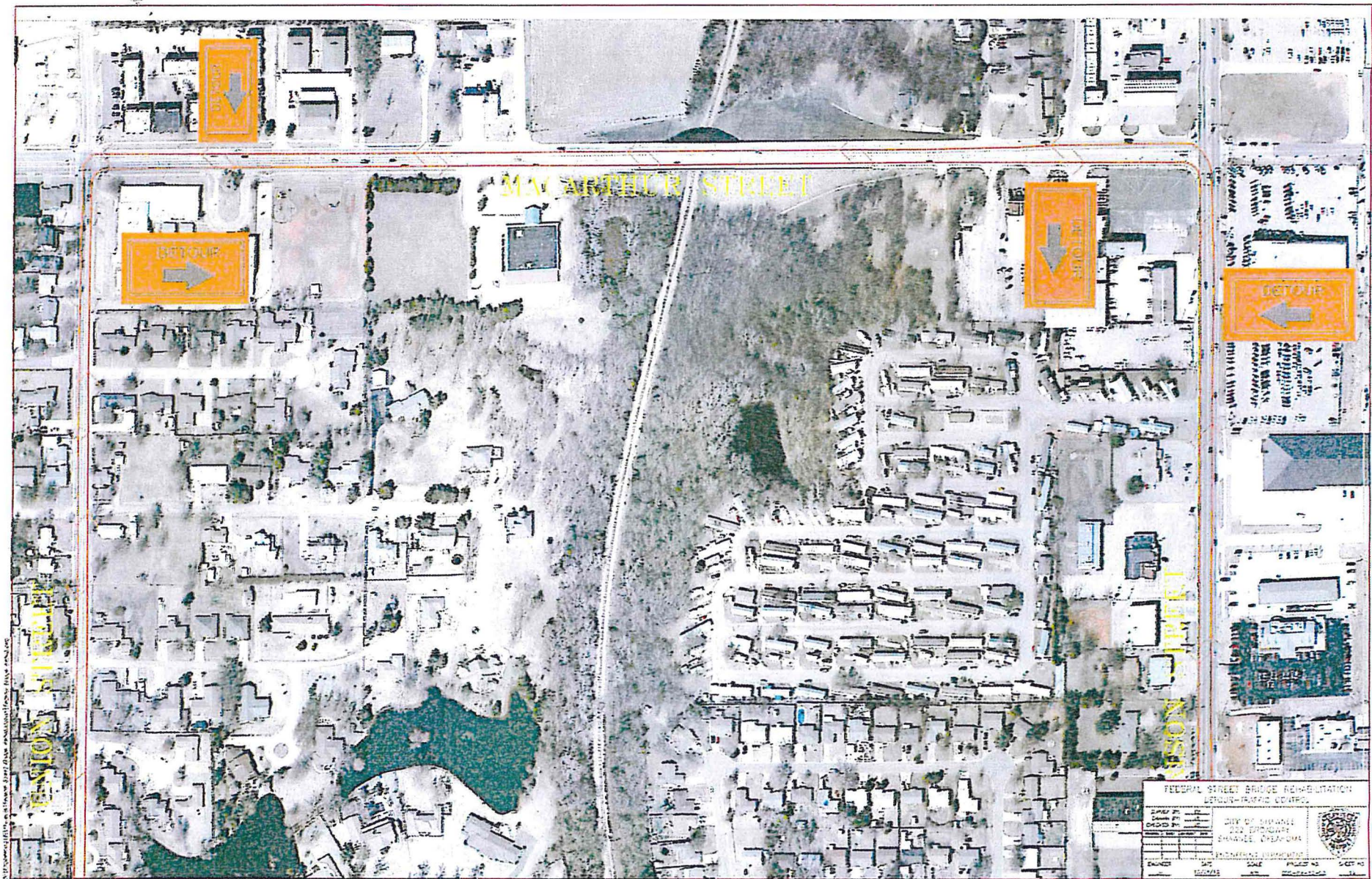

© 2011 City of Chicago, Department of Transportation. All rights reserved.

**FEDERAL STREET BRIDGE REHABILITATION**  
 GROUP-BRIDGE CONTRACT

DATE	BY	SCALE	PROJECT NO.	SHEET NO.

CITY OF CHICAGO  
 DEPARTMENT OF TRANSPORTATION  
 CHICAGO, ILLINOIS



**NOTICE TO BIDDERS**

Sealed bids will be received by the City of Shawnee, Oklahoma, City Hall, 16 West 9<sup>th</sup> – P.O Box 1448, Shawnee, OK 74802-1448 up to 4:00 p.m., **Monday, December 17, 2012**, for:

**BID: CONTRACT NO. COS-PW-12-02  
FEDERAL STREET BRIDGE REHAB PROJECT**

Bidding Documents, Plans and Specifications are available to qualified bidders at the office of City Engineer, 222 North Broadway, Shawnee, OK 74801. The fee for Plans and Specifications is \$50.00 per contract set and is non-refundable. No documents will be mailed unless the request is accompanied by an additional \$10.00 per set to cover mailing cost. **A Pre-Bid Conference is scheduled for Wednesday, December 5, 2012, at 11:00 a.m. in the Engineering Conference Room, 222 North Broadway, Shawnee, OK.**

Each bid shall be filed in a sealed envelope. On the front of each envelope shall be written the following words to the left of the address:

**BID: CONTRACT NO. COS-PW-12-02  
FEDERAL STREET BRIDGE REHAB PROJECT  
December 17, 2012**

This project shall include **the complete removal of deck, approaches, sidewalks and parapets of the bridge to be put back as designed. As well as, the construction of new slope wall, repair of piers, beams, and columns, and addition of a throw fence. This bridge is within the R/W of the BNSF railroad and will be handled accordingly.** BIDDERS must obtain Bid Documents directly from the City of Shawnee in order for Bids to be acknowledged. The ORIGINAL COPY of each bid shall be filed with the City Clerk of the City of Shawnee, Oklahoma, together with a sworn anti-collusion affidavit in writing that the bidder has not entered into any agreement, expressed or implied, with any other bidder, or bidders, for the purpose of limiting the bid, or bidders, or parcel out to any bidder, or bidders or any other persons, any part of the contract or subject matter of the bid.

Each BIDDER shall attach to his/her BID filed with the City of Shawnee either a bidder's bond, a certified check, or a cashier's check made payable to the City of Shawnee, in an amount not less than five percent (5%) of the amount of bid as a guarantee of delivery of the service in full compliance with the specifications as issued by the City of Shawnee. Should the successful BIDDER fail to deliver the service in full compliance with the specifications within forty-five (45) days after acceptance of his/her bid, the bidder's bond, certified check or cashier's check deposited with his/her bid will be retained as and for liquidated damages. The deposit of each unsuccessful bidder will be returned when his/her bid is rejected.

The bids filed with the City Clerk will be opened and considered by the Board of Commissioners at a Public Meeting in the City Hall, Shawnee, Oklahoma, at 6:30 p.m., **Monday, December 17, 2012**. The City of Shawnee reserves the right to reject any and all bids.

CITY OF SHAWNEE, OKLAHOMA  
a Municipal Corporation



BY: \_\_\_\_\_  
Brian E. McDougal, City Manager

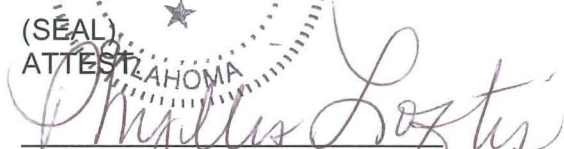

(SEAL)  
ATTEST  
  
Phyllis Loftis, CMC, City Clerk

CITY OF SHAWNEE  
PLAN HOLDER'S LIST  
CONTRACT NO. COS-PW-12-02  
FEDERAL STREET BRIDGE REHAB PROJECT

Business Name: GIBSON & ASSOCIATES, INC  
Contact: Pam Davis  
Address: 11210 Ryliecrest  
Balch Springs, Texas 75180-0579  
Telephone: 972-557-1199  
Fax: 972-557-1552  
Cell: \_\_\_\_\_  
E-Mail: pamd@gibsonassoc.net  
Paid for & Picked Up Specs: 11/15/12 check # 60133 fedex

Business Name: MERIDIAN CONTRACTING, INC  
Contact: Edith Owens / Trace Musgrave  
Address: 17500 S. Sooner Road  
Norman, Ok 73071  
Telephone: 520-878-0500 ext. 232 /405-928-5959  
Fax: 520-878-0501 / 405-928-5554  
Cell: \_\_\_\_\_  
E-Mail: t.musgrave@meridiancon.net  
Paid for & Picked Up Specs: 11/26/12 ck # 49602 mailed

Business Name: OBC Inc  
Contact: Patrick Rother  
Address: PO Box 3817  
Edmond, Ok 73083  
Telephone: 405-263-7787  
Fax: 405-513-6786  
Cell: 405-226-9914  
E-Mail: prother@obcinc.biz  
Paid for & Picked Up Specs: 11/27/12 ck # 32293

Business Name: C-P INTEGRATED  
Contact: Steve Conley  
Address: 3800 Beacon Dr. Okc, Ok 73179  
  
Telephone: 405-732-0532  
Fax: 405-732-0502  
Cell: 405-823-2147  
E-Mail: steveconley@coxinet.net  
Paid for & Picked Up Specs: 12/5/12 credit

Business Name: CIMARRON CONSTRUCTION CO  
Contact: Travis Lloyd  
Address: 7409 N.W. 85<sup>th</sup> Street  
OKC, OK 73132  
Telephone: 405-728-1555  
Fax: 405-728-5026  
Cell: 405-535-7036  
E-Mail: tlloydcimarronconstructionco.com  
Paid for & Picked Up Specs: 12/5/12 ck# 7052

Business Name: PBX CORPORATION  
Contact: Logan Hudspeth  
Address: P.O. Box 644  
Supulpa, OK 74067  
Telephone: 918-227-9650  
Fax: 918-227-9637  
Cell: 918-740-7593  
E-Mail: loganh@pbxcorp.com  
Paid for & Picked Up Specs: 12/5/12 ck# 5207

Business Name: SAC SERVICES  
Contact: Joe Martinez  
Address: 3600 S. Ross Ave.  
OKC, OK 73119  
Telephone: 405-684-9057  
Fax: 405-686-0882  
Cell: 405-834-9092  
E-Mail: sacservicesmtz@yahoo.com  
Paid for & Picked Up Specs: 12/5/12 ck #35069

Business Name: \_\_\_\_\_  
Contact: \_\_\_\_\_  
Address: \_\_\_\_\_  
\_\_\_\_\_  
Telephone: \_\_\_\_\_  
Fax: \_\_\_\_\_  
Cell: \_\_\_\_\_  
E-Mail: \_\_\_\_\_  
Paid for & Picked Up Specs: \_\_\_\_\_

Business Name: \_\_\_\_\_  
Contact: \_\_\_\_\_  
Address: \_\_\_\_\_  
\_\_\_\_\_  
Telephone: \_\_\_\_\_  
Fax: \_\_\_\_\_  
Cell: \_\_\_\_\_  
E-Mail: \_\_\_\_\_  
Paid for & Picked Up Specs: \_\_\_\_\_

**Regular Board of Commissioners**

6. b.

**Meeting Date:** 01/22/2013

Bell St Sidewalk (Open)

Submitted By: Donna Mayo, Administration

Department: Administration

---

Information

Title of Item for Agenda

Bell Street Sidewalk Project Contract No. COS-PW-12-03 (Open)

**RECESS CITY COMMISSION MEETING TO CONVENE SHAWNEE MUNICIPAL AUTHORITY AND SHAWNEE AIRPORT AUTHORITY**

**RECONVENE CITY COMMISSION MEETING**

---

Attachments

Notice to Bidders

Bidders List

**NOTICE TO BIDDERS**

Sealed bids will be received by the City of Shawnee, Oklahoma, City Hall, 16 West 9<sup>th</sup> – P.O. Box 1448, Shawnee, OK 74802-1448 up to 4:00 p.m., **Tuesday, January 22, 2013**, for:

**BID: CONTRACT NO. COS-PW-12-03  
BELL STREET SIDEWALK PROJECT**

Bidding Documents, Plans and Specifications are available to qualified bidders at the office of City Engineer, 222 North Broadway, Shawnee, OK 74802-1448. The fee for Plans and Specifications is \$50.00 per contract set and is non-refundable. No documents will be mailed unless the request is accompanied by an additional \$5.00 per set to cover mailing cost. **A Pre-Bid Conference is scheduled for Wednesday, January 9, 2013, at 11:00 a.m. in the Engineering Conference Room, 222 North Broadway, Shawnee, OK.**

Each bid shall be filed in a sealed envelope. On the front of each envelope shall be written the following words to the left of the address:

**BID: CONTRACT NO. COS-PW-12-03  
BELL STREET SIDEWALK PROJECT  
January 22, 2013**

This project shall include approximately **the construction of a four (4) foot wide concrete sidewalks along Bell Street from Farrall to Seventh Street with the addition of an enhanced lighted crosswalk at Farrall and Bell.** BIDDERS must obtain Bid Documents directly from the City of Shawnee in order for Bids to be acknowledged. The ORIGINAL COPY of each bid shall be filed with the City Clerk of the City of Shawnee, Oklahoma, together with a sworn anti-collusion affidavit in writing that the bidder has not entered into any agreement, expressed or implied, with any other bidder, or bidders, for the purpose of limiting the bid, or bidders, or parcel out to any bidder, or bidders or any other persons, any part of the contract or subject matter of the bid.

Each BIDDER shall attach to his/her BID filed with the City of Shawnee either a bidder's bond, a certified check, or a cashier's check made payable to the City of Shawnee, in an amount not less than five percent (5%) of the amount of bid as a guarantee of delivery of the service in full compliance with the specifications as issued by the City of Shawnee. Should the successful BIDDER fail to deliver the service in full compliance with the specifications within forty-five (45) days after acceptance of his/her bid, the bidder's bond, certified check or cashier's check deposited with his/her bid will be retained as and for liquidated damages. The deposit of each unsuccessful bidder will be returned when his/her bid is rejected.

The bids filed with the City Clerk will be opened and considered by the Board of Commissioners at a Public Meeting in the City Hall, Shawnee, Oklahoma, at 6:30 p.m., **Tuesday, January 22, 2013.** The City of Shawnee reserves the right to reject any and all bids.

  
ATTEST:  
  
Phyllis Loftis, CMC, City Clerk

CITY OF SHAWNEE, OKLAHOMA  
a Municipal Corporation

BY:   
Brian E. McDougal, City Manager



CITY OF SHAWNEE  
PLAN HOLDER'S LIST  
CONTRACT NO. COS-PW-12-03  
BELL STREET SIDEWALK PROJECT

(Highlighted Contractors have sent Addendum Receipt)

Business Name: Tom Hudson Paving  
Contact: Tom Hudson  
Address: 7400 W. HWY 33  
Guthrie, OK 73044  
Telephone: 405-341-9305  
Fax: \_\_\_\_\_  
Cell: 405-641-5113  
E-Mail: tomhudsonpaving@aol.com  
Paid for & Picked Up Specs: mailed 12/28/12 ck # 29361

Business Name: Parathon Construction  
Contact: Jimmy Smith  
Address: PO Box 1287  
Edmond, OK 73083-1287  
Telephone: 405-202-0643  
Fax: 866-391-1572  
Cell: 202-0643  
E-Mail: jimmy-smith@coxiney.net  
Paid for & Picked Up Specs: 1/4/13 ck # 1810

Business Name: Rudy Construction  
Contact: Phil Pratt  
Address: PO Box 14575  
OKC, OK 73113  
Telephone: 478-9900  
Fax: 478-9901  
Cell: 417-1753  
E-Mail: pprat@rudyconstruction.com  
Paid for & Picked Up Specs: 1/5/13 ck # 53042

Business Name: Traffic & Lighting Systems  
Contact: Jennifer Sullivan  
Address: 13305 N. Sante Fe  
OKC, OK 73114  
Telephone: 405-524-1341  
Fax: 405-524-2386  
Cell: \_\_\_\_\_  
E-Mail: Jennifer@tlsokc.com  
Paid for & Picked Up Specs: 1/8/13 ck # 070135

Business Name: C-P Integrated  
Contact: Steve Conley  
Address: 3800 Beacon Dr.  
OKC, OK 73179  
Telephone: 405-732-0532  
Fax: 405-732-0502  
Cell: 405-823-2147  
E-Mail: steveconley@coxinet.net  
Paid for & Picked Up Specs: 1/8/13 Cash

Business Name: White's Construction  
Contact: Chuck White  
Address: 2019 Spencer DR.  
Harrah, OK 73045  
Telephone: 405-248-2279  
Fax: 405-454-3036  
Cell: 405-248-2279  
E-Mail: cwhitesconstruction@att.com  
Paid for & Picked Up Specs: 1/9/13 credit

2

Business Name: Kustom Krete  
Contact: Chris Conley  
Address: 1901 Glenn Wood Dr  
Moore, OK 73160  
Telephone: 405-205-0513  
Fax: \_\_\_\_\_  
Cell: 405-205-0513  
E-Mail: chris,kustomkrete@yahoo.com  
Paid for & Picked Up Specs: 1/9/13 cash

Business Name: A-Tech Paving  
Contact: Josh Payne  
Address: 7845 N. Robinson Suite H  
OKC, OK 73116  
Telephone: 405-418-4741  
Fax: 405-418-4743  
Cell: \_\_\_\_\_  
E-Mail: jpayne@atechpaving.com  
Paid for & Picked Up Specs: 1/9/13 ck # 059282

Business Name: Young Contracting  
Contact: Katy Watson  
Address: 10900 Hefner Pointe Dr. Suite 202  
OKC, OK 73120  
Telephone: 405-286-5588  
Fax: 405-286-5589  
Cell: \_\_\_\_\_  
E-Mail: kwatson@mlyoung.com  
Paid for & Picked Up Specs: 1/9/13 mailed ck # 2610

Business Name: All Roads Paving  
Contact: Dave Barnett  
Address: 10200 N.W. 10<sup>th</sup>  
OKC, OK 73127  
Telephone: 405-577-2944  
Fax: 405-577-2942  
Cell: 405-990-5255  
E-Mail: allroadspaving@coxinet.net  
Paid for & Picked Up Specs: 1/11/13 CK #7196

Business Name: \_\_\_\_\_  
Contact: \_\_\_\_\_  
Address: \_\_\_\_\_  
\_\_\_\_\_  
Telephone: \_\_\_\_\_  
Fax: \_\_\_\_\_  
Cell: \_\_\_\_\_  
E-Mail: \_\_\_\_\_  
Paid for & Picked Up Specs: \_\_\_\_\_

Business Name: \_\_\_\_\_  
Contact: \_\_\_\_\_  
Address: \_\_\_\_\_  
\_\_\_\_\_  
Telephone: \_\_\_\_\_  
Fax: \_\_\_\_\_  
Cell: \_\_\_\_\_  
E-Mail: \_\_\_\_\_  
Paid for & Picked Up Specs: \_\_\_\_\_

**Regular Board of Commissioners**

**10.**

**Meeting Date:** 01/22/2013

Exec Session

Submitted By: Donna Mayo, Administration

Department: Administration

---

Information

Title of Item for Agenda

Consider an Executive Session to discuss potential claims, litigation or other options regarding encroachment into City's utility service area by other entities as authorized by 25 O.S. §307(B)(4).

---

**Regular Board of Commissioners**

**11.**

**Meeting Date:** 01/22/2013

Exec Session action

Submitted By: Donna Mayo, Administration

Department: Administration

---

Information

Title of Item for Agenda

Consider matters discussed in Executive Session regarding discuss potential claims, litigation or other options regarding encroachment into City's utility service area by other entities as authorized by 25 O.S. §307(B)(4).

---